

RoHS

This products can apply to the SWB Doc NO. QA-3-04-005 of Environmental&Material Management Rules

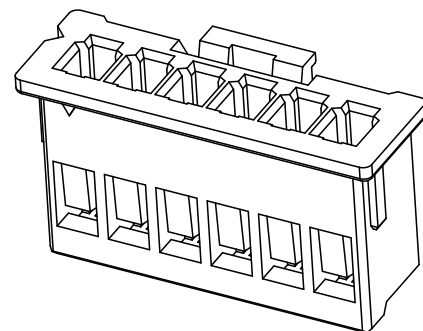
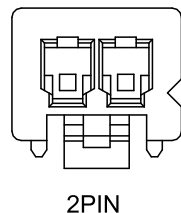
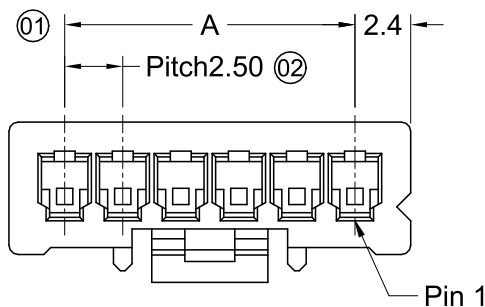

Specifications :

- Voltage rating: 250V AC / DC
- Current rating: 3A AC / DC
- Withstanding voltage: 1000V AC/minute
- Temperature range: -40°C~+105°C
- Insulation resistance: ≥1000MΩ
- Contact resistance: ≤10mΩ
- After environmental testing: ≤20mΩ
- Suitable SWB Terminal: 2508T
- Mates With SWB Wafer: 2508W

2508 H X XX X-N0 XX - X
 ① ② ③ ④ ⑤ ⑥ ⑦ ⑧

- ① Series No.
- ② Category: H-HSG
- ③ Appearance type: Blank-ordinary
- ④ Row No.-Pin No.: XX-Single Row
- ⑤ Special No.: Blank-Ordinary
B-Special Packing
- ⑥ Material : N0-PA66 94V-0
- ⑦ Color: Blank-Natural Color
- ⑧ C- The glow-wire test of 750°C

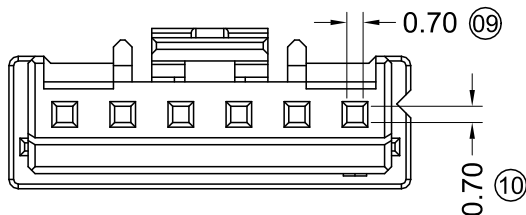
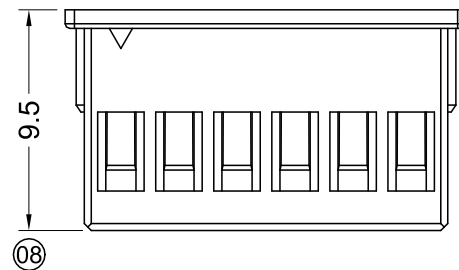
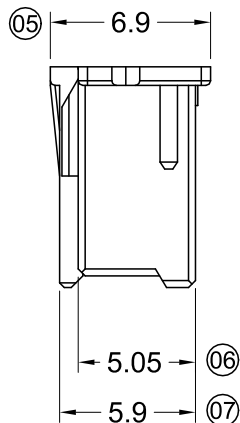
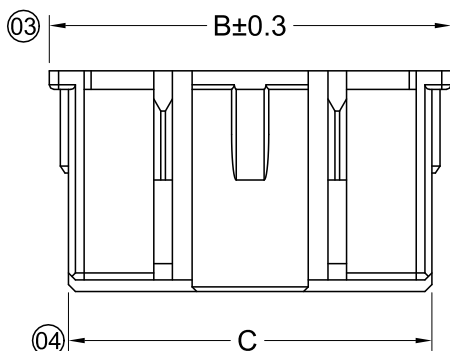

Poles	Dimensions (mm)		
	A	B	C
02	2.50	7.30	5.65
03	5.00	9.80	8.15
04	7.50	12.30	10.65
05	10.00	14.80	13.15
06	12.50	17.30	15.65
07	15.00	19.80	18.15
08	17.50	22.30	20.65
09	20.00	24.80	23.15
10	22.50	27.30	25.65
11	25.00	29.80	28.15
12	27.50	32.30	30.65
13	30.00	34.80	33.15
14	32.50	37.30	35.65
15	35.00	39.80	38.15

2021/05/06	C	EN120210506001	Add new product type	TengMin	John Yang
2020/03/31	B	EN20200331001	Update Drawing Frame	Zeng	Robing
2017/08/11	A	/	Initial release	Alan qin	Guo
DATE	REV	ECN NO.	DESCRIPTION	MODIFY	APPROVAL

GENERAL TOLERANCE	
.X	±0.30
.XX	±0.20
.XXX	±0.10
X.°	±2°
PROJECT	

东莞市思索连接器有限公司
 SWB CONNECTORS CO.,LTD

APPROVAL	CHECK	DRAWN	DATE
Smark	Guo	Alan qin	2017/08/11

PART NO. 2508H-XXX-N0-X				
TITLE 2.50 mm Crimp Style connectors				
UNIT	SCALE	SHEET	REV	NUMBER
mm	1:1	1/3	C	A-022

RoHS

This products can apply to the SWB Doc NO. QA-3-04-005 of Environmental&Material Management Rules

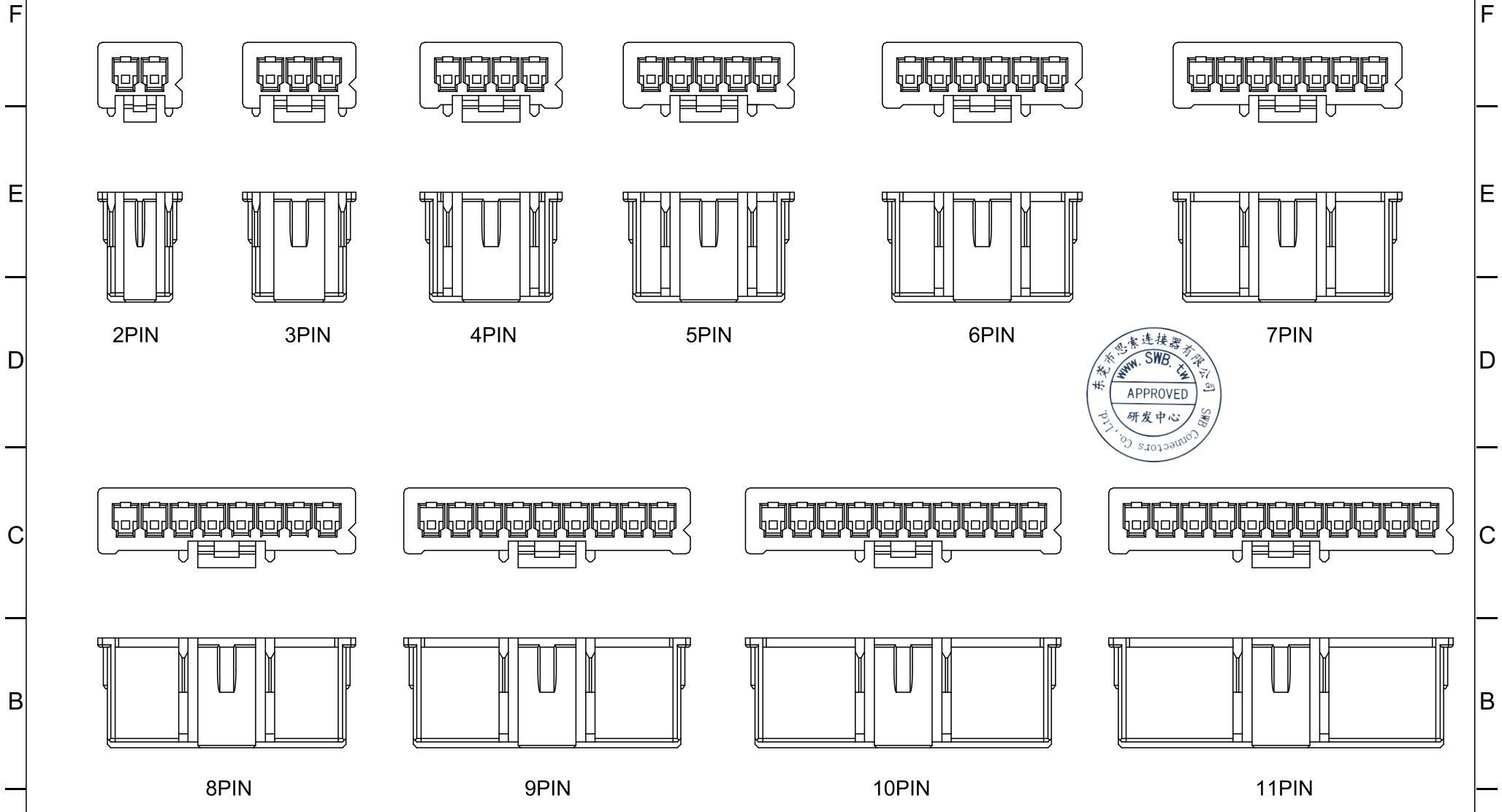

2021/05/06	C	EN120210506001	Add new product type	TengMin	John Yang	GENERAL TOLERANCE .X ±0.30 .XX ±0.20 .XXX ±0.10 X.° ±2° PROJECT 	东莞市思索连接器有限公司 SWB CONNECTORS CO.,LTD				PART NO. 2508H-XXX-N0-X				
2020/03/31	B	EN20200331001	Update Drawing Frame	Zeng	Robing						APPROVAL CHECK DRAWN DATE Smark Guo Alan qin 2017/08/11				TITLE 2.50 mm Crimp Style connectors
2017/08/11	A	/	Initial release	Alan qin	Guo						UNIT	SCALE	SHEET	REV	NUMBER
DATE	REV	ECN NO.	DESCRIPTION	MODIFY	APPROVAL						mm	1:1	2/3	C	A-022

RoHS

This products can apply to the SWB Doc NO. QA-3-04-005 of Environmental&Material Management Rules

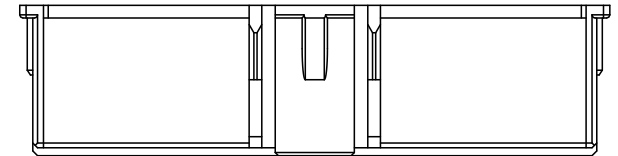
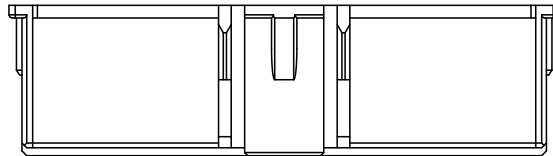
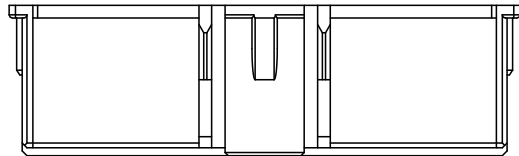
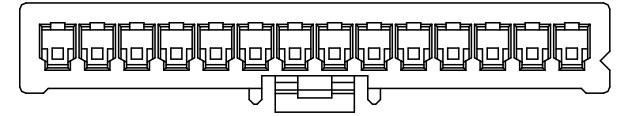
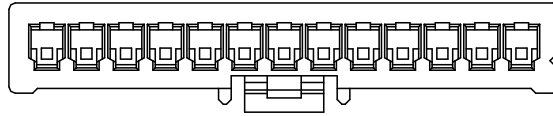
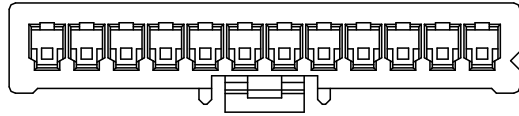

12PIN

13PIN

14PIN

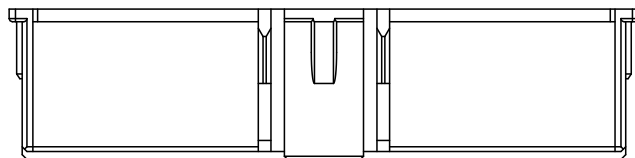
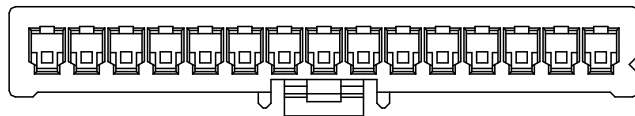

15PIN



2021/05/06	C	EN120210506001	Add new product type	TengMin	John Yang
2020/03/31	B	EN20200331001	Update Drawing Frame	Zeng	Robing
2017/08/11	A	/	Initial release	Alan qin	Guo
DATE	REV	ECN NO.	DESCRIPTION	MODIFY	APPROVAL

GENERAL TOLERANCE
.X ±0.30
.XX ±0.20
.XXX ±0.10
X.° ±2°
PROJECT

东莞市思索连接器有限公司
SWB CONNECTORS CO.,LTD

APPROVAL	CHECK	DRAWN	DATE
Smark	Guo	Alan qin	2017/08/11

PART NO. 2508H-XXX-N0-X				
TITLE 2.50 mm Crimp Style connectors				
UNIT	SCALE	SHEET	REV	NUMBER
mm	1:1	3/3	C	A-022

F

E

D

C

B

A

F

E

D

C

B

A

1

2

3

4

5

6

7

8

1

2

3

4

5

6

7

8

RoHS

This products can apply to the SWB Doc NO. QA-3-04-005 of Environmental&Material Management Rules

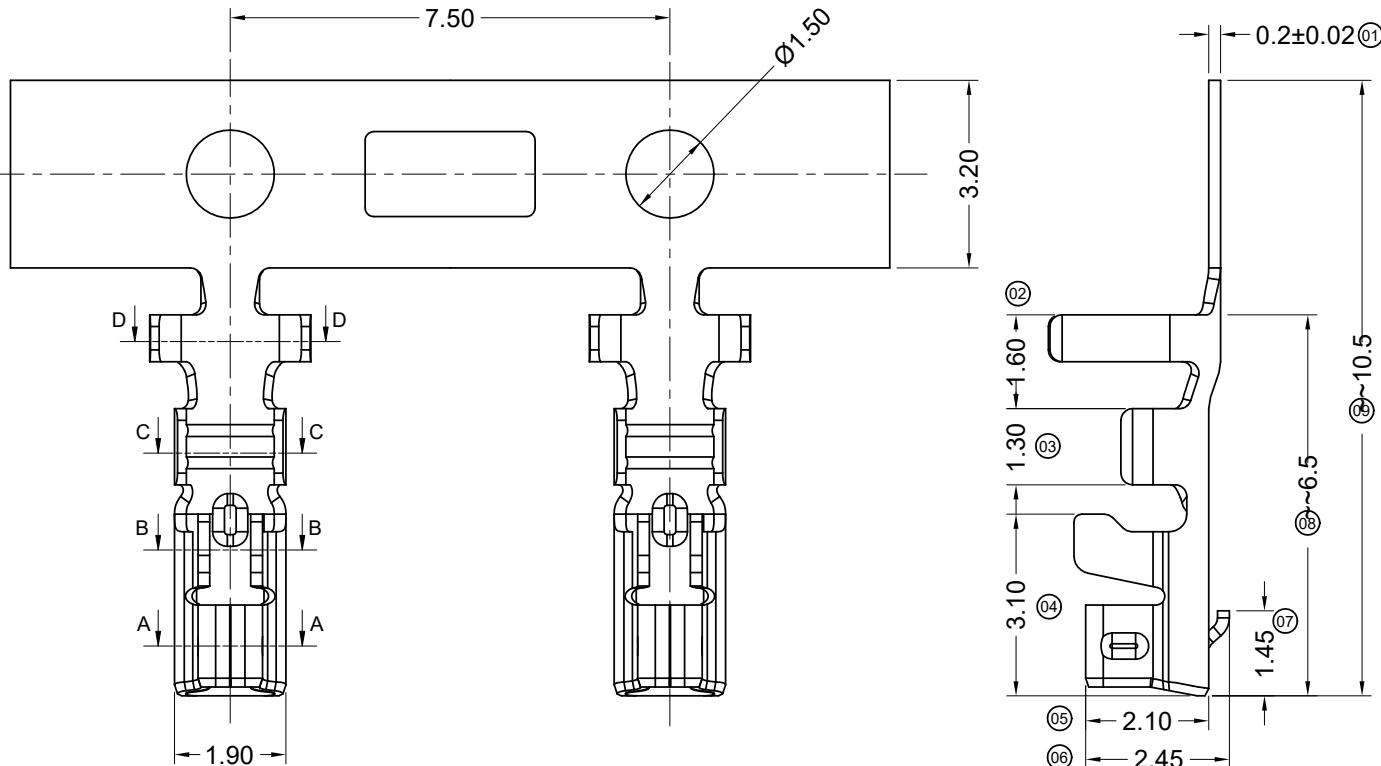

- Specifications
- Voltage rating: 250V AC / DC
 - Current rating:
 - AWG22#:3A AC / DC
 - AWG24#~26#:2A AC / DC
 - Withstanding voltage: 1000V AC/minute
 - Temperature range: -40°C~+105°C
 - Insulation resistance: ≥1000MΩ
 - Contact resistance: ≤10mΩ
 - After environmental testing: ≤20mΩ
 - Wire Size:AWG#22~26(0.35~0.13mm²)
 - Insulation O.D.:1.60mm (Max)
 - Mates with SWB Housing: 2508H

2508 T X-P SN1 X-X
① ② ③ ④ ⑤ ⑥ ⑦



- ① Series No.
- ② Category:T-Terminal
- ③ Shape:Blank-ordinary
- ④ Material:P-Phosphor bronze
- ⑤ Plating Style:
SN1-Underplate:Ni 40~120u" (1~3um) overall
Top plating:Sn 80~200u"(2~5um) overall
- ⑥ Plating Method:
Blank-Stamping before plating
- ⑦ Mold No./Mark/Special No.

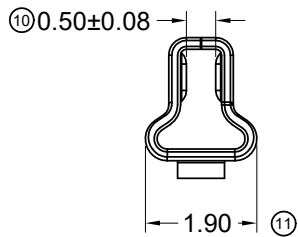

SECTION: A-A
SCALE: 1:1

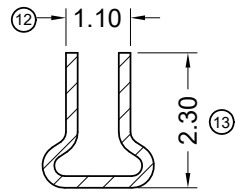

SECTION: B-B
SCALE: 1:1

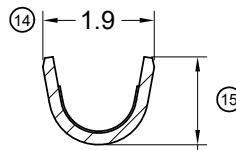

SECTION: C-C
SCALE: 1:1

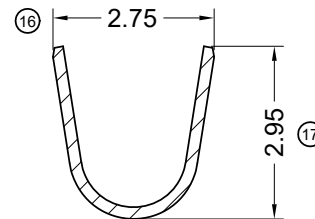

SECTION: D-D
SCALE: 1:1

					<p>GENERAL TOLERANCE</p> <p>.X ±0.30</p> <p>.XX ±0.20</p> <p>.XXX ±0.10</p> <p>X.° ±2°</p>				<p>东莞市思索连接器有限公司</p> <p>SWB CONNECTORS CO.,LTD</p>				<p>PART NO. 2508T-PSN1</p>								
					<p>APPROVAL</p> <p>Smark</p>				<p>CHECK</p> <p>Guo</p>				<p>DRAWN</p> <p>Alan qin</p>				<p>DATE</p> <p>2017/06/23</p>				
					<p>PROJECT</p> <p>① ②</p>								<p>TITLE</p> <p>2.50 mm Crimp Style connectors</p>								
													<p>UNIT</p> <p>mm</p>								
													<p>SCALE</p> <p>8:1</p>								
													<p>SHEET</p> <p>1/1</p>								
													<p>REV</p> <p>C</p>								
													<p>NUMBER</p> <p>A-000</p>								

2021/03/23	C	ER20210323001	Add current information	Wang	John Yang
2020/03/31	B	EN20200331001	Update Drawing Frame	Zeng	Robing
DATE	REV	ECN NO.	DESCRIPTION	MODIFY	APPROVAL

1 2 3 4 5 6 7 8

RoHS

This products can apply to the SWB Doc NO. QA-3-04-005 of Environmental&Material Management Rules

Specifications :

- Voltage rating: 250V AC / DC
- Current rating: 3A AC / DC
- Withstanding voltage:1000V AC/minute
- Temperature range: -40°C~+105°C
- Insulation resistance:≥1000MΩ
- Contact resistance:≤10mΩ
- After environmental testing: ≤20mΩ
- Material(Pin):Brass
- Mates With SWB Housing:2508H

2508 W V X-XX XX- N0 SN XX X
 ① ② ③ ④ ⑤ ⑥ ⑦ ⑧ ⑨ ⑩

- ① Series No.
- ② Category: W-WAFER
- ③ Connector Type: V-Straight 180°
- ④ Mouting Type: Blank-DIP
- ⑤ Row No.-Pin No.: XX-02P~15P
- ⑥ Special No.:
 Blank-Without a Post、 With Kink
 N1-Without a Post、 Without Kink
 P- With a Post、 With Kink
 P1-With a Post、 Without Kink
- ⑦ Material: N0-PA66 94V-0
- ⑧ Plating Code: SN-Bright Tin Plating
- ⑨ Color : Blank-Natural Color
- ⑩ Packing : Blank-PE Bag、 T-Tray

Poles	Dimensions (mm)		Poles	Dimensions (mm)	
	A	B		A	B
02	2.50	7.50	09	20.00	25.00
03	5.00	10.00	10	22.50	27.50
04	7.50	12.50	11	25.00	30.00
05	10.00	15.00	12	27.50	32.50
06	12.50	17.50	13	30.00	35.00
07	15.00	20.00	14	32.50	37.50
08	17.50	22.50	15	35.00	40.00

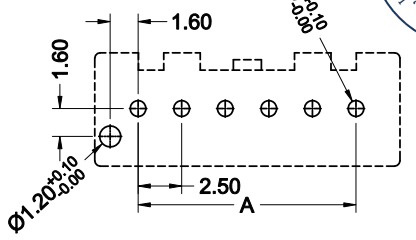
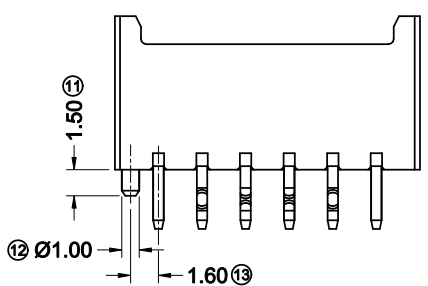
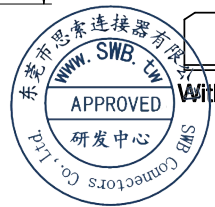
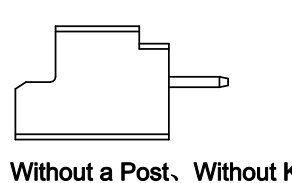
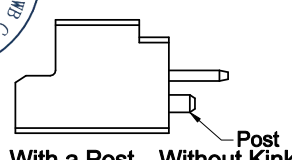
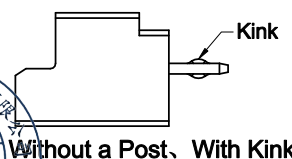
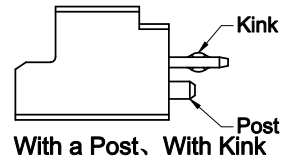
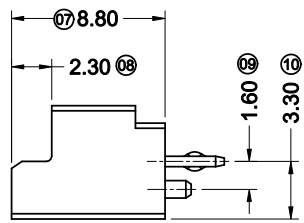
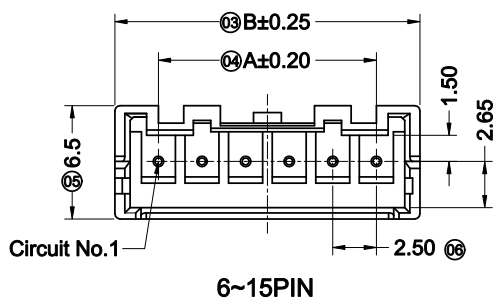
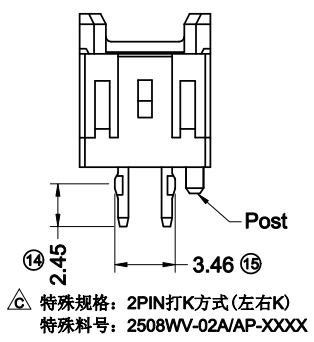
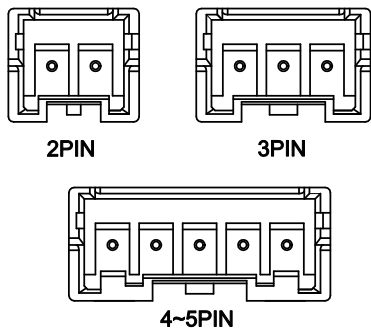
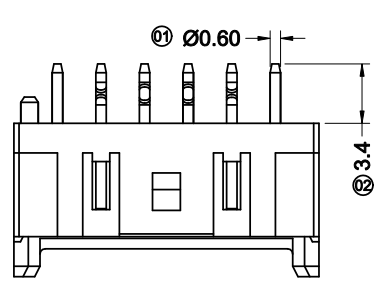

RECOMMENDED P.C.B LAYOUT (TOLERANCE:±0.05)

DATE	REV	ECN NO	DESCRIPTION	MODIFY	APPROVAL
2020/10/10	D	ER120201010001	Remove matte tin plating code	TengMin	Harvey Yan
2020/09/21	C	EN20200921001	02 Pin K view to add special specifications	Zeng	Robing
2020/03/31	B	EN20200331001	Update Drawing Frame	Zeng	Robing

GENERAL TOLERANCE	
.X	±0.30
.XX	±0.20
.XXX	±0.10
X°	±2°
PROJECT	
Symbol	

东莞市思索连接器有限公司
 SWB CONNECTORS CO.,LTD

APPROVAL: Smark, CHECK: Guo, DRAWN: Alan qin, DATE: 2017/11/21

PART NO.				
2508WV-XXXX-N0SNXX				
TITLE				
2.50 mm Crimp Style connectors				
UNIT	SCALE	SHEET	REV	NUMBER
mm	1:1	1/2	D	A-000

RoHS

This products can apply to the SWB Doc NO. QA-3-04-005 of Environmental&Material Management Rules

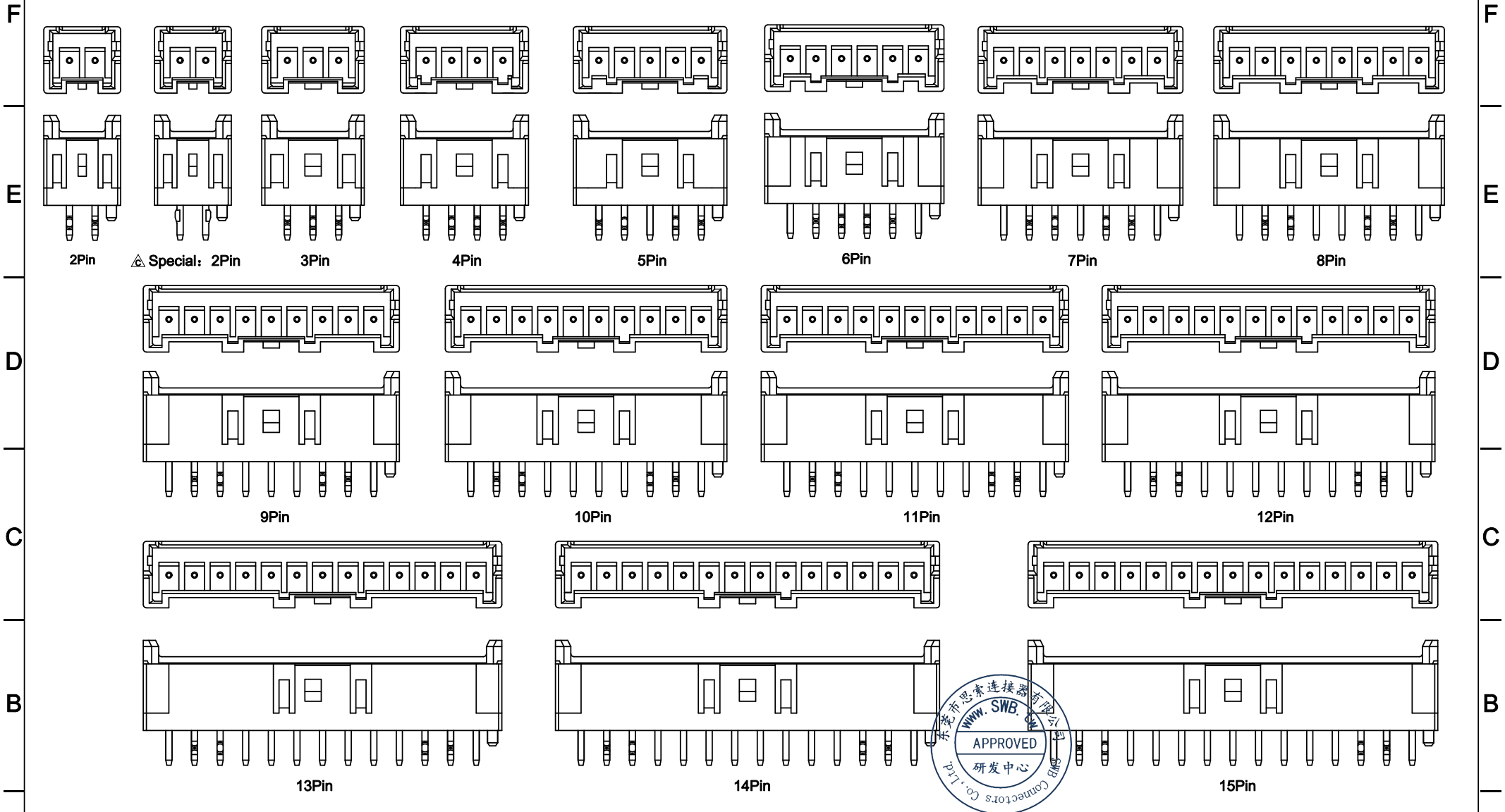

A	2020/10/10	D	ER120201010001	Remove matte tin plating code	TengMin	Harvey Yan	 东莞市思索连接器有限公司 SWB CONNECTORS CO.,LTD				PART NO. 2508WV-XXXX-N0SNXX					
	2020/09/21	C	EN20200921001	02 Pin K view to add special specifications	Zeng	Robing					TITLE 2.50 mm Crimp Style connectors					
	2020/03/31	B	EN20200331001	Update Drawing Frame	Zeng	Robing					APPROVAL	CHECK	DRAWN	DATE	UNIT SCALE SHEET REV NUMBER	
	DATE	REV	ECN NO	DESCRIPTION	MODIFY	APPROVAL					Smark	Guo	Alan qin	2017/11/21	mm	1:1

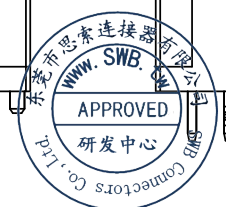

RoHS

This products can apply to the SWB Doc NO. QA-3-04-005 of Environmental&Material Management Rules

- Specifications :
- Voltage rating: 250V AC / DC
 - Current rating: 3A AC / DC
 - Withstanding voltage:1000V AC/minute
 - Temperature range: -40°C~+125°C
 - Insulation resistance:≥1000MΩ
 - Contact resistance: ≤10mΩ
 - After environmental testing: ≤20mΩ
 - Material(Pin):Brass
 - Mates With SWB Housing:2508H

2508 W V X-XX XX- XX XX XX X

① ② ③ ④ ⑤ ⑥ ⑦ ⑧ ⑨ ⑩

- ① Series No.
- ② Category:W-WAFER
- ③ Welding Board Angle: V-Straight 180°
- ④ Welding Way: Blank-DIP
- ⑤ Row No.-Pin No.: XX-02P~15P
- ⑥ Special No.:
Blank-Without a boss、 With Kink
N1-Without a boss、 Without Kink
P- With a boss、 With Kink
P1-With a boss、 Without Kink
- ⑦ Material: 9T-PA9T 94V-0
- ⑧ Plating Category: SN-Bright Tin Plating
V01-Gold Flash
- ⑨ Color : Blank-Natural Color
- ⑩ Packing : Blank-Bag T-Tray C-Reel(With CAP)

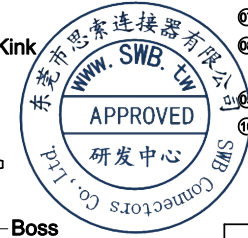

Poles	Dimensions (mm)		Poles	Dimensions (mm)	
	A	B		A	B
02	2.50	7.50	09	20.00	25.00
03	5.00	10.00	10	22.50	27.50
04	7.50	12.50	11	25.00	30.00
05	10.00	15.00	12	27.50	32.50
06	12.50	17.50	13	30.00	35.00
07	15.00	20.00	14	32.50	37.50
08	17.50	22.50	15	35.00	40.00

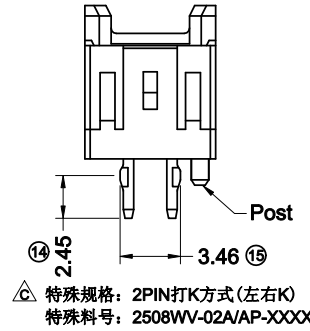
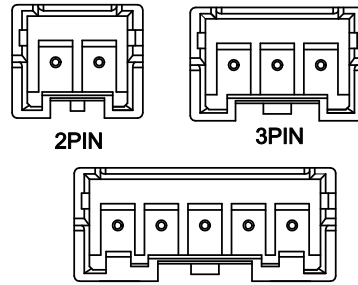
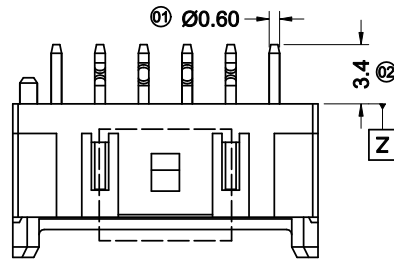

特殊规格: 2PIN打K方式(左右K)
特殊料号: 2508WV-02A/AP-XXXX

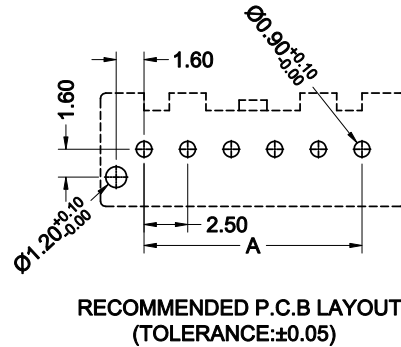
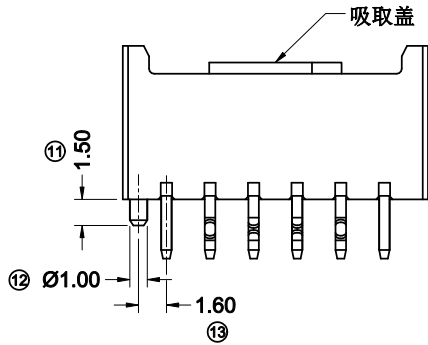
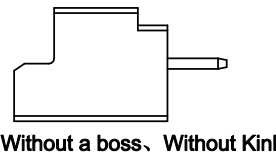
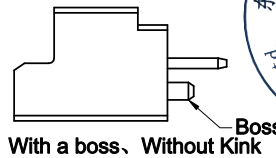
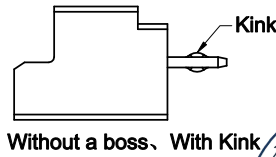
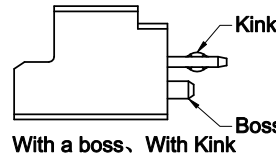
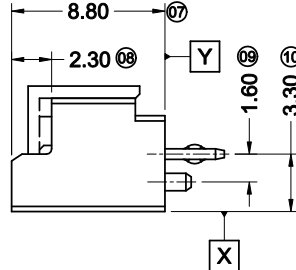
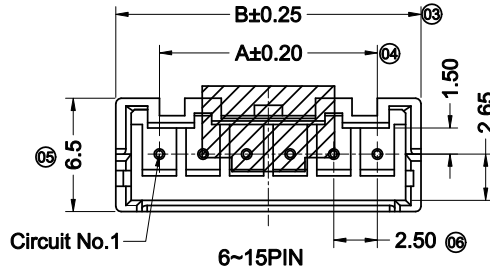

RECOMMENDED P.C.B LAYOUT
(TOLERANCE:±0.05)

GENERAL TOLERANCE					APPROVAL				PART NO.				
.X ±0.30					东莞市思索连接器有限公司 SWB CONNECTORS CO.,LTD APPROVAL CHECK DRAWN DATE Alan qin 2017/11/21				2508WV-XXXX-9TXXXX				
.XX ±0.20									TITLE				
.XXX ±0.10									2.50 mm Crimp Style connectors				
X° ±2°									UNIT SCALE SHEET REV NUMBER				
2021/08/18	E	EN20210818002	Add with cap p/n	Mali	Alan qin								
DATE	REV	ECN NO	DESCRIPTION	MODIFY	APPROVAL	mm 1:1 1/2 E A-000							

RoHS

This products can apply to the SWB Doc NO. QA-3-04-005 of Environmental&Material Management Rules

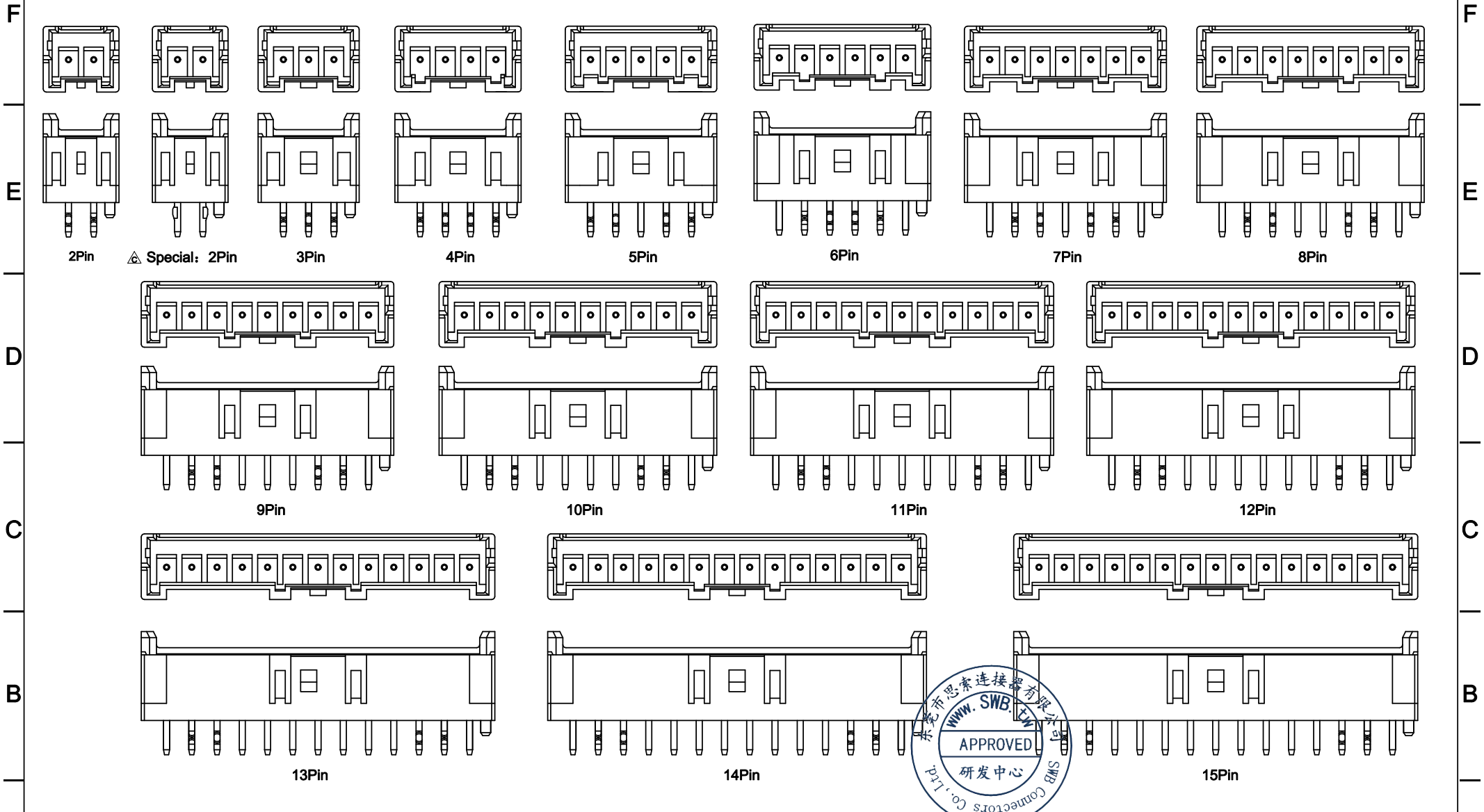

					GENERAL TOLERANCE .X ±0.30 .XX ±0.20 .XXX ±0.10 X° ±2° PROJECT 				PART NO. 2508WV-XXXX-9TXXXXX						
					APPROVAL CHECK DRAWN DATE Alan qin 2017/11/21				TITLE 2.50 mm Crimp Style connectors						
2021/08/18	E	EN20210818002	Add with cap p/n	Mali	Alan qin						UNIT	SCALE	SHEET	REV	NUMBER
DATE	REV	ECN NO	DESCRIPTION	MODIFY	APPROVAL						mm	1:1	2/2	E	A-000

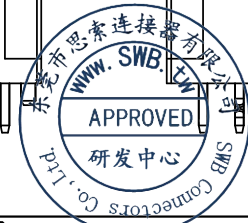

东莞市思索连接器有限公司
SWB CONNECTORS CO.,LTD

RoHS

This products can apply to the SWB Doc NO. QA-3-04-005 of Environmental&Material Management Rules

Poles	Dimensions (mm)		Poles	Dimensions (mm)	
	A	B		A	B
02	2.50	7.50	09	20.00	25.00
03	5.00	10.00	10	22.50	27.50
04	7.50	12.50	11	25.00	30.00
05	10.00	15.00	12	27.50	32.50
06	12.50	17.50	13	30.00	35.00
07	15.00	20.00	14	32.50	37.50
08	17.50	22.50	15	35.00	40.00

Specifications :

- Voltage rating: 250V AC / DC
- Current rating: 3A AC / DC
- Withstanding voltage:1000V AC/minute
- Temperature range: -40°C~+125°C
- Insulation resistance:≥1000MΩ
- Contact resistance: ≤10mΩ
- After environmental testing: ≤20mΩ
- Material(Pin):Brass
- Mates With SWB Housing:2508H、2513H

2508 W R X-XX X- 9T SN X X
 ① ② ③ ④ ⑤ ⑥ ⑦ ⑧ ⑨ ⑩

- ① Series No.
- ② Category: W-Wafer
- ③ Connector Type: R-Right angle 90°
- ④ Mouting Type: Blank-DIP
- ⑤ Row No.-Pin No.: XX-02P~15P
- ⑥ Special No.:N-Without post and without kink
 △ Blank-Without post and with kink
- ⑦ Material: 9T-PA9T UL94V-0
- ⑧ Plating Code: SN-Bright Tin Plating
 Underplate:Ni 40~120u"(1~3um) overall
 Top plating:Sn 80~200u"(2~5um) overall
- ⑨ Color : Blank-Natural color
- ⑩ Packing : Blank-PE bag、 T-Tray

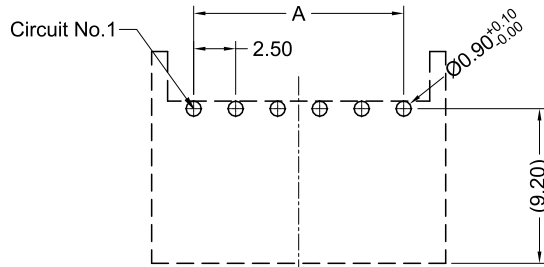
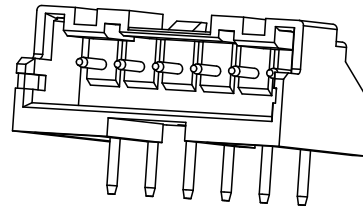
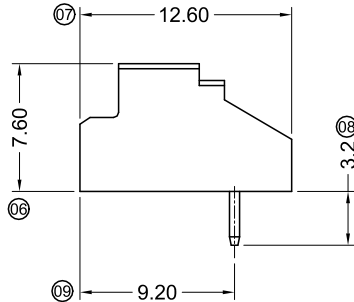
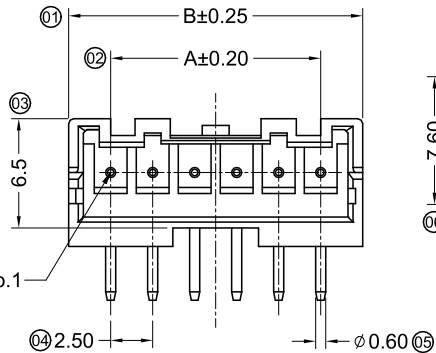
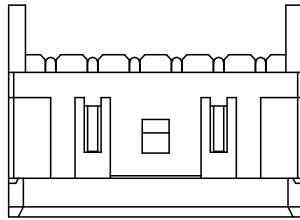

RECOMMENDED P.C.B LAYOUT T=1.60mm (TOLERANCE:±0.05)

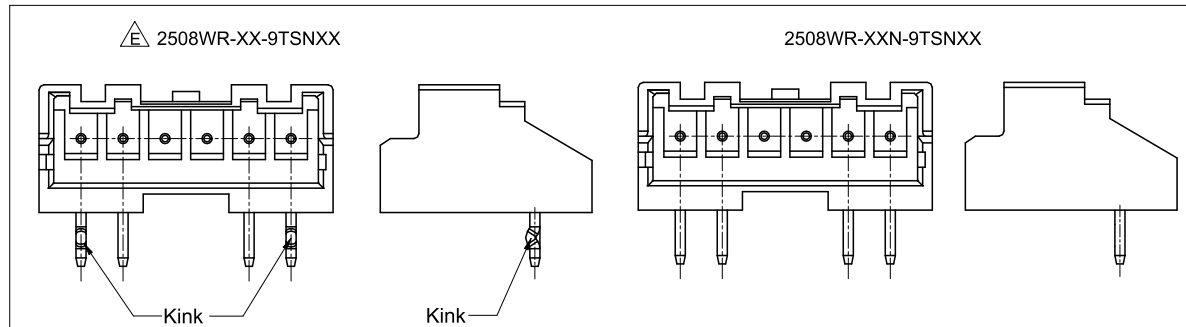

DATE	REV	ECN NO.	DESCRIPTION	MODIFY	APPROVAL	PROJECT	APPROVAL	CHECK	DRAWN	DATE	UNIT	SCALE	SHEET	REV	NUMBER	
2021/03/31	E	EN120210331001	Add the specification with kink	Xin Qing	John Yang	GENERAL TOLERANCE	东莞市思索连接器有限公司 SWB CONNECTORS CO.,LTD	Smark	Guo	Alan qin	2018/04/16	mm	1:1	1/2	E	A-000
2020/10/10	D	ER120201010001	Remove matte tin plating code	TengMin	Harvey Yan	.X ±0.30										
2020/03/31	C	EN20200331001	Update Drawing Frame, The Same ECR And ECN NO.	Zeng	Robing	.XX ±0.20										
						.XXX ±0.10										
						X.° ±2°										

PART NO. 2508WR-XXX-9TSNXX

TITLE 2.50 mm Crimp Style connectors

UNIT SCALE SHEET REV NUMBER
 mm 1:1 1/2 E A-000

RoHS

This products can apply to the SWB Doc NO. QA-3-04-005 of Environmental&Material Management Rules

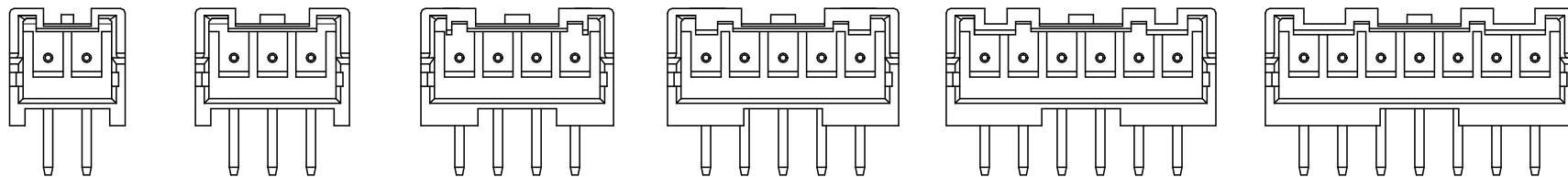

2Pin

3Pin

4Pin

5Pin

6Pin

7Pin

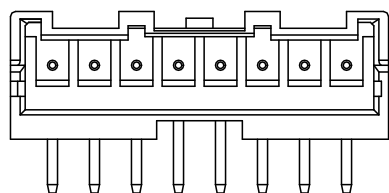

8Pin

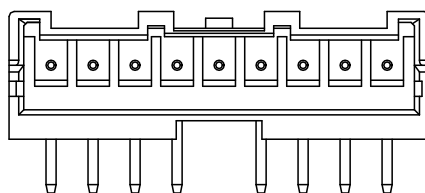

9Pin

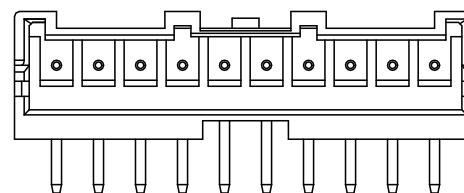

10Pin

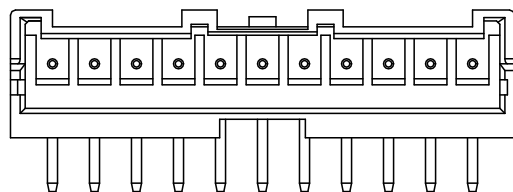

11Pin

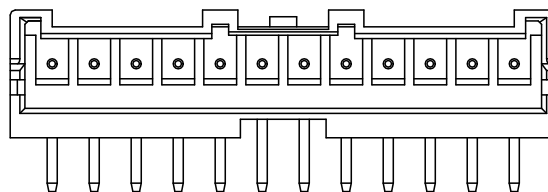

12Pin

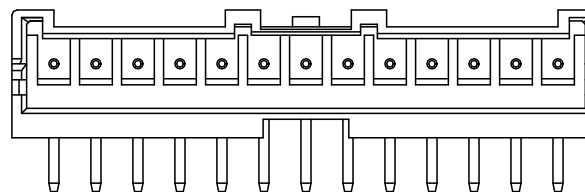

13Pin

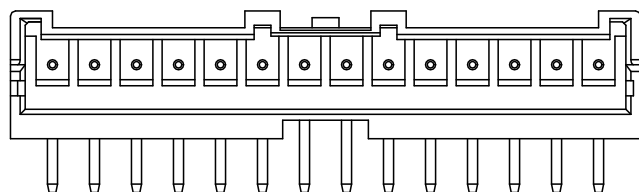

14Pin

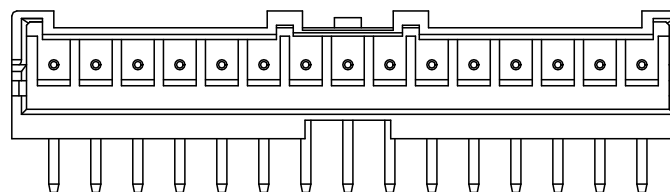

15Pin



2021/03/31	E	EN120210331001	Add the specification with kink	Xin Qing	John Yang	<table border="1"> <tr> <th colspan="2">GENERAL TOLERANCE</th> </tr> <tr> <td>.X</td> <td>±0.30</td> </tr> <tr> <td>.XX</td> <td>±0.20</td> </tr> <tr> <td>.XXX</td> <td>±0.10</td> </tr> <tr> <td>X.°</td> <td>±2°</td> </tr> <tr> <td colspan="2">PROJECT</td> </tr> <tr> <td></td> <td></td> </tr> </table>	GENERAL TOLERANCE		.X	±0.30	.XX	±0.20	.XXX	±0.10	X.°	±2°	PROJECT				<p>东莞市思索连接器有限公司 SWB CONNECTORS CO.,LTD</p>	PART NO. 2508WR-XXX-9TSNXX			
GENERAL TOLERANCE																									
.X	±0.30																								
.XX	±0.20																								
.XXX	±0.10																								
X.°	±2°																								
PROJECT																									
2020/10/10	D	ER120201010001	Remove matte tin plating code	TengMin	Harvey Yan	TITLE 2.50 mm Crimp Style connectors																			
2020/03/31	C	EN20200331001	Update Drawing Frame, The Same ECR And ECN NO.	Zeng	Robing	APPROVAL	CHECK	DRAWN	DATE																
DATE	REV	ECN NO.	DESCRIPTION	MODIFY	APPROVAL	Smark	Guo	Alan qin	2018/04/16																
UNIT		SCALE	SHEET	REV	NUMBER																				
mm		1:1	2/2	E	A-000																				

RoHS

This products can apply to the SWB Doc NO. QA-3-04-005 of Environmental&Material Management Rules

Poles	Dimensions (mm)		Poles	Dimensions (mm)	
	A	B		A	B
02	2.50	7.50	09	20.00	25.00
03	5.00	10.00	10	22.50	27.50
04	7.50	12.50	11	25.00	30.00
05	10.00	15.00	12	27.50	32.50
06	12.50	17.50	13	30.00	35.00
07	15.00	20.00	14	32.50	37.50
08	17.50	22.50	15	35.00	40.00

Specifications :

- Voltage rating: 250V AC / DC
- Current rating: 3A AC / DC
- Withstanding voltage:1000V AC/minute
- Temperature range: -40°C~+125°C
- Insulation resistance:≥1000MΩ
- Contact resistance: ≤10mΩ
- After environmental testing: ≤20mΩ
- Material(Pin):Brass
- Mates With SWB Housing:2508H、2513H

2508 W R X-XX X-9T SN X X
 ① ② ③ ④ ⑤ ⑥ ⑦ ⑧ ⑨ ⑩

- ① Series No.
- ② Category: W-Wafer
- ③ Connector Type: R-Right angle 90°
- ④ Mouting Type: Blank-DIP
- ⑤ Row No.-Pin No.: XX-02P~15P
- ⑥ Special No.:S-With post and with kink
 △ S1-With post and without kink
- ⑦ Material: 9T-PA9T UL94V-0
- ⑧ Plating Code: SN-Bright Tin Plating
 Underplate:Ni 40~120u"(1~3um) overall
 Top plating:Sn 80~200u"(2~5um) overall
- ⑨ Color : Blank-Natural color; GW-Grey
- ⑩ Packing : Blank-PE bag、T-Tray



F

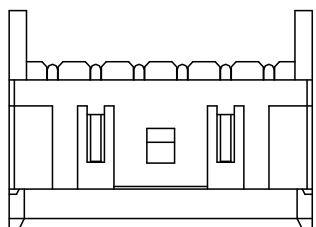

E

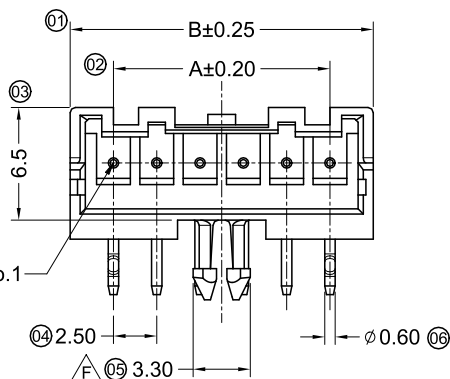

D

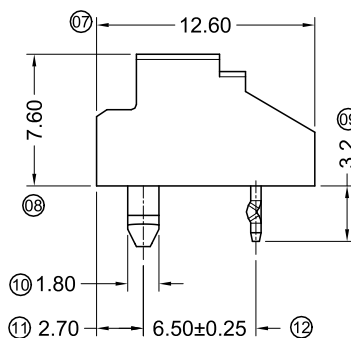

C

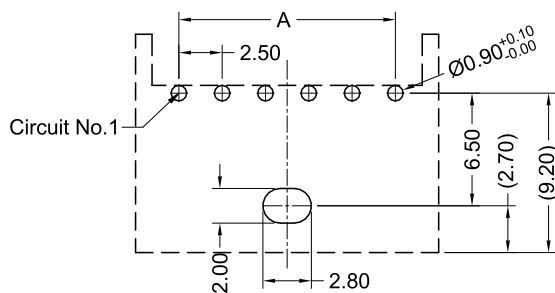

B

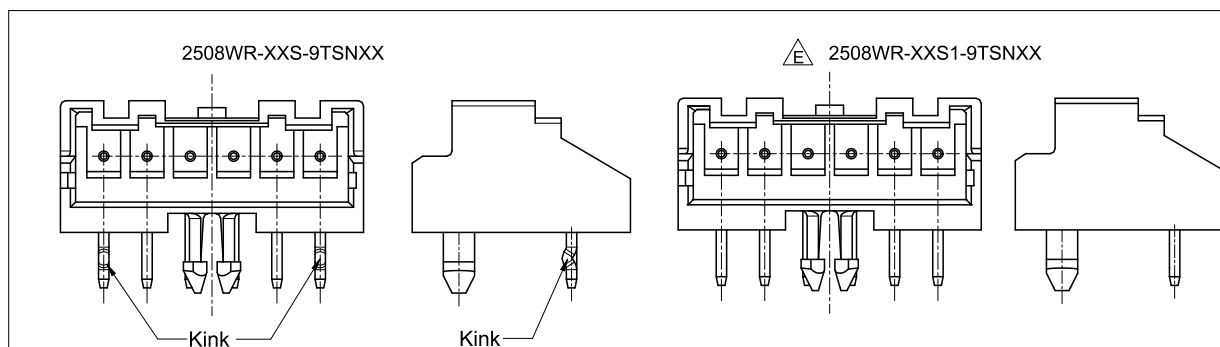

A

DATE	REV	ECN NO.	DESCRIPTION	MODIFY	APPROVAL	PROJECT	APPROVAL				DATE	UNIT	SCALE	SHEET	REV	NUMBER
2021/05/06	F	EN120210506001	Modify the post structure	Cai Zhao	John Yang	GENERAL TOLERANCE	东莞市思索连接器有限公司 SWB CONNECTORS CO.,LTD	PART NO. 2508WR-XXX-9TSNXX	TITLE 2.50 mm Crimp Style connectors	Smark Guo Alan qin 2017/11/21	DATE	mm	1:1	1/2	F	A-000
2021/03/31	E	EN120210331001	Add the specification without kink	Xin Qing	John Yang	.X ±0.30										
2020/10/10	D	ER120201010001	Remove matte tin plating code	TengMin	Harvey Yan	.XX ±0.20										
						.XXX ±0.10										
						X.° ±2°										

1

2

3

4

5

6

7

8

A

RoHS

This products can apply to the SWB Doc NO. QA-3-04-005 of Environmental&Material Management Rules

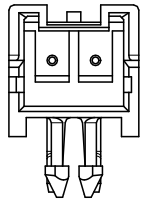

2Pin

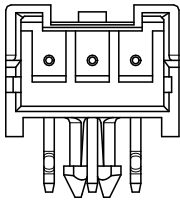

3Pin

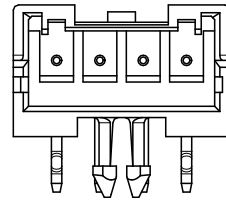

4Pin

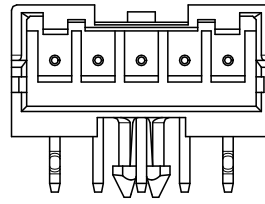

5Pin

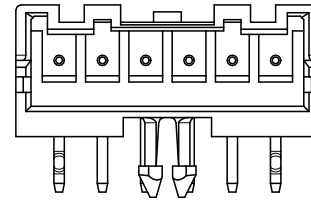

6Pin

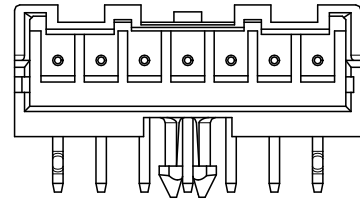

7Pin

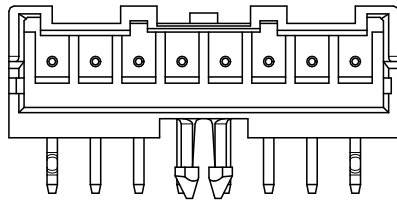

8Pin

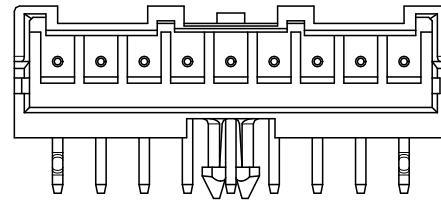

9Pin

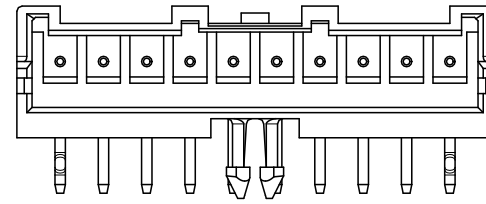

10Pin

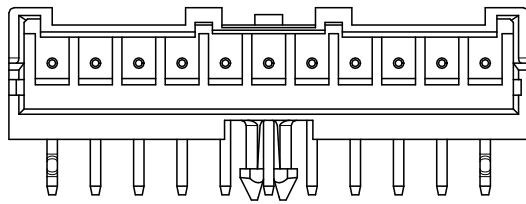

11Pin

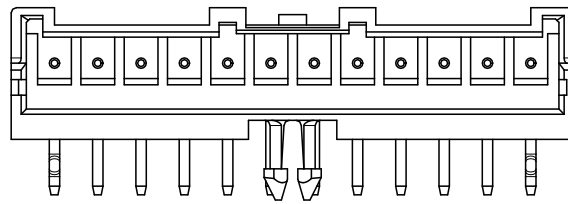

12Pin

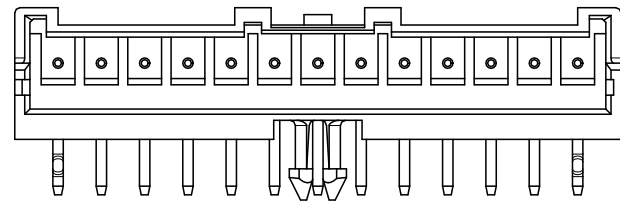

13Pin

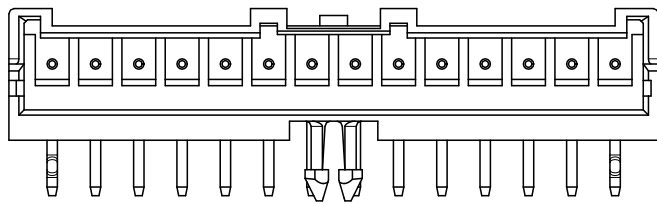

14Pin

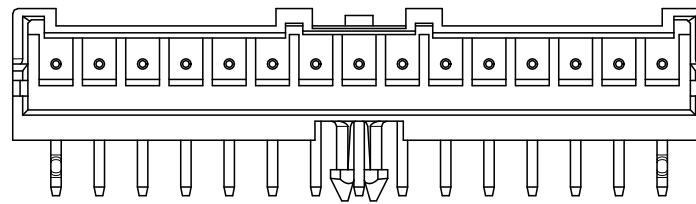

15Pin



2021/05/06	F	EN120210506001	Modify the post structure	Cai Zhao	John Yang	GENERAL TOLERANCE .X ±0.30 .XX ±0.20 .XXX ±0.10 X.° ±2° PROJECT 	东莞市思索连接器有限公司 SWB CONNECTORS CO.,LTD				PART NO. 2508WR-XXX-9TSNXX					
2021/03/31	E	EN120210331001	Add the specification without kink	Xin Qing	John Yang						APPROVAL CHECK DRAWN DATE Smark Guo Alan qin 2017/11/21				TITLE 2.50 mm Crimp Style connectors	
2020/10/10	D	ER120201010001	Remove matte tin plating code	TengMin	Harvey Yan							UNIT	SCALE	SHEET	REV	NUMBER
DATE	REV	ECN NO.	DESCRIPTION	MODIFY	APPROVAL							mm	1:1	2/2	F	A-000

RoHS

This products can apply to the SWB Doc NO. QA-3-04-005 of Environmental&Material Management Rules

Poles	Dimensions (mm)		Poles	Dimensions (mm)	
	A	B		A	B
02	2.50	7.50	09	20.00	25.00
03	5.00	10.00	10	22.50	27.50
04	7.50	12.50	11	25.00	30.00
05	10.00	15.00	12	27.50	32.50
06	12.50	17.50	13	30.00	35.00
07	15.00	20.00	14	32.50	37.50
08	17.50	22.50	15	35.00	40.00

Specifications :

- Voltage rating: 250V AC / DC
- Current rating: 3A AC / DC
- Withstanding voltage:1000V AC/minute
- Temperature range: -40°C~+125°C
- Insulation resistance:≥1000MΩ
- Contact resistance: ≤10mΩ
- After environmental testing: ≤20mΩ
- Material(Pin):Brass
- Mates With SWB Housing:2508H、 2513H

2508 W R X-XX X-N0 SN X X - X
⑪ ⑫ ⑬ ⑭ ⑮ ⑯ ⑰ ⑱ ⑲ ⑩ ①

- ⑪ Series No.
- ⑫ Category: W-Wafer
- ⑬ Connector Type: R-Right angle 90°
- ⑭ Mounting Type: Blank-DIP
- ⑮ Row No.-Pin No.: XX-02P~15P
- ⑯ Special No.:N-Without post and without kink
△ Blank-Without post and with kink
- ⑰ Material: N0-PA66 UL94V-0
- ⑱ Plating Code: SN-Bright Tin Plating
Underplate:Ni 40~120u"(1~3um) overall
Top plating:Sn 80~200u"(2~5um) overall
- ⑲ Color : Blank-Natural color;GW-Grey;R-Red △
- ⑩ Packing : Blank-PE bag、 T-Tray
- ① C- The glow-wire test of 750°C △

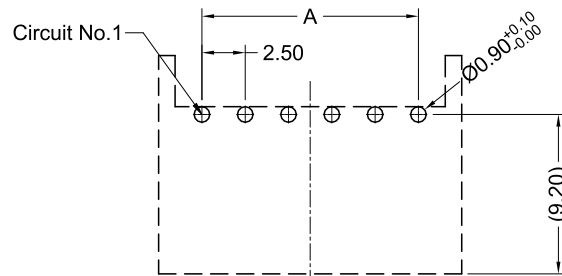
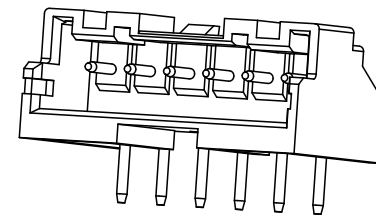
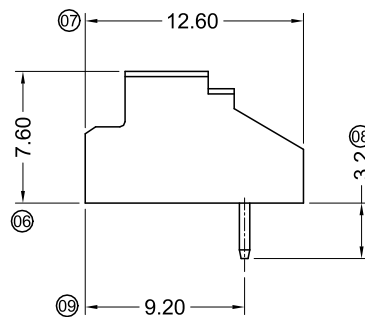
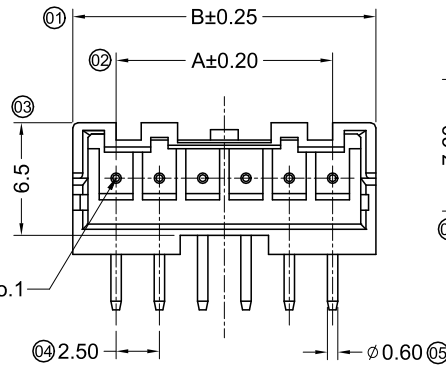
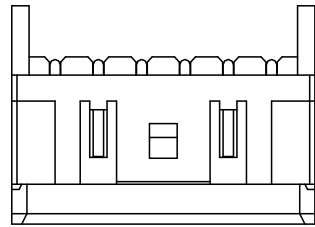

RECOMMENDED P.C.B LAYOUT T=1.60mm (TOLERANCE:±0.05)

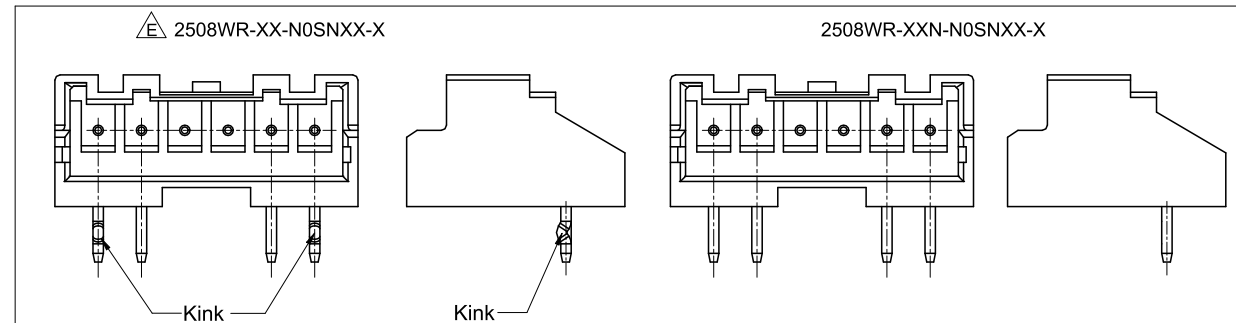

2021/05/06	F	EN120210506001	Add new product type	TengMin	John Yang
2021/03/31	E	EN120210331001	Add the specification with kink and red	Xin Qing	John Yang
2020/10/10	D	ER120201010001	Remove matte tin plating code	TengMin	Harvey Yan
DATE	REV	ECN NO.	DESCRIPTION	MODIFY	APPROVAL



东莞市思索连接器有限公司
SWB CONNECTORS CO.,LTD

APPROVAL	CHECK	DRAWN	DATE
Smark	Guo	Alan qin	2018/04/16

PART NO. 2508WR-XXX-N0SNXX-X				
TITLE 2.50 mm Crimp Style connectors				
UNIT	SCALE	SHEET	REV	NUMBER
mm	1:1	1/2	F	A-000

RoHS

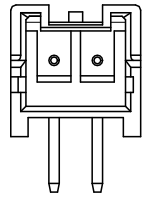
This products can apply to the SWB Doc NO. QA-3-04-005 of Environmental&Material Management Rules



2Pin

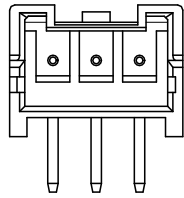

3Pin

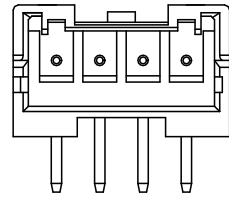

4Pin

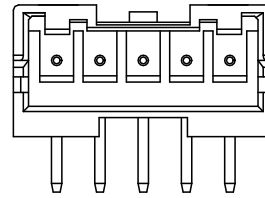

5Pin

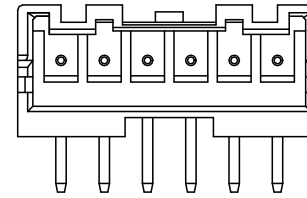

6Pin

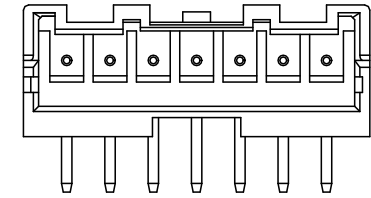

7Pin

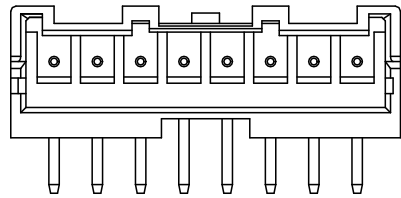

8Pin

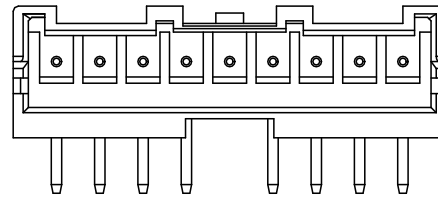

9Pin

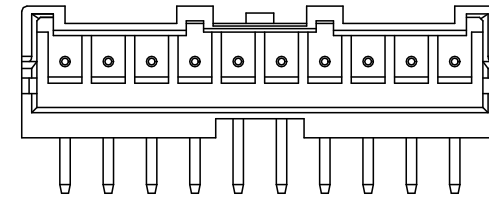

10Pin

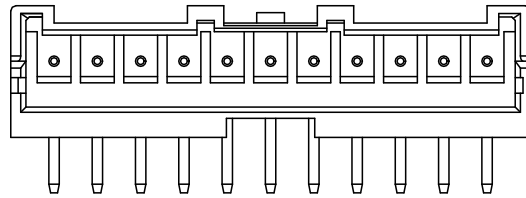

11Pin

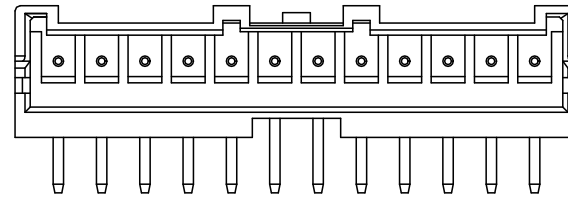

12Pin

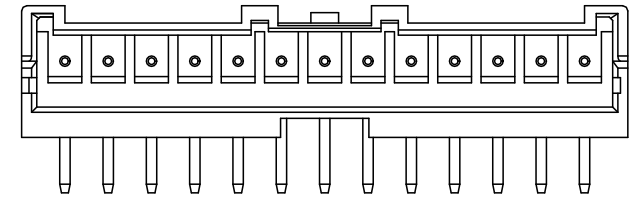

13Pin

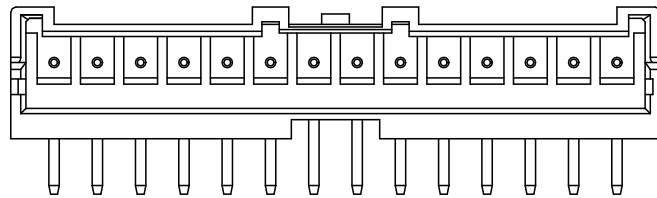

14Pin

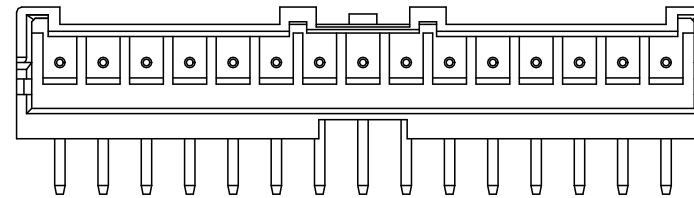

15Pin



2021/05/06	F	EN120210506001	Add new product type	TengMin	John Yang
2021/03/31	E	EN120210331001	Add the specification with kink and red	Xin Qing	John Yang
2020/10/10	D	ER120201010001	Remove matte tin plating code	TengMin	Harvey Yan
DATE	REV	ECN NO.	DESCRIPTION	MODIFY	APPROVAL

GENERAL TOLERANCE	
.X	±0.30
.XX	±0.20
.XXX	±0.10
X.°	±2°
PROJECT	

东莞市思索连接器有限公司
SWB CONNECTORS CO.,LTD

APPROVAL	CHECK	DRAWN	DATE
Smark	Guo	Alan qin	2018/04/16

PART NO. 2508WR-XXX-N0SNXX-X				
TITLE 2.50 mm Crimp Style connectors				
UNIT	SCALE	SHEET	REV	NUMBER
mm	1:1	2/2	F	A-000

F
E
D
C
B

F
E
D
C
B

A

A

1 | 2 | 3 | 4 | 5 | 6 | 7 | 8

RoHS

This products can apply to the SWB Doc NO. QA-3-04-005 of Environmental&Material Management Rules

Poles	Dimensions (mm)		Poles	Dimensions (mm)	
	A	B		A	B
02	2.50	7.50	09	20.00	25.00
03	5.00	10.00	10	22.50	27.50
04	7.50	12.50	11	25.00	30.00
05	10.00	15.00	12	27.50	32.50
06	12.50	17.50	13	30.00	35.00
07	15.00	20.00	14	32.50	37.50
08	17.50	22.50	15	35.00	40.00

■ Specifications :

- Voltage rating: 250V AC / DC
- Current rating: 3A AC / DC
- Withstanding voltage:1000V AC/minute
- Temperature range: -40°C~+125°C
- Insulation resistance:≥1000MΩ
- Contact resistance: ≤10mΩ
- After environmental testing: ≤20mΩ
- Material(Pin):Brass
- Mates With SWB Housing:2508H、 2513H

2508 W R X-XX X- N0 SN X X - X
 ① ② ③ ④ ⑤ ⑥ ⑦ ⑧ ⑨ ⑩ ⑪

- ① Series No.
- ② Category: W-Wafer
- ③ Connector Type: R-Right angle 90°
- ④ Mounting Type: Blank-DIP
- ⑤ Row No.-Pin No.: XX-02P~15P
- ⑥ Special No.:S-With post and with kink
 △ S1-With post and without kink
- ⑦ Material: N0-PA66 UL94V-0
- ⑧ Plating Code: SN-Bright Tin Plating
 Underplate:Ni 40~120u"(1~3um) overall
 Top plating:Sn 80~200u"(2~5um) overall
- ⑨ Color : Blank-Natural color; GW-Grey;R-Red △
- ⑩ Packing : Blank-PE bag、 T-Tray
- ⑪ C- The glow-wire test of 750°C △

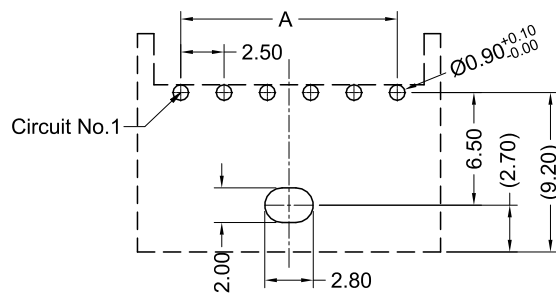
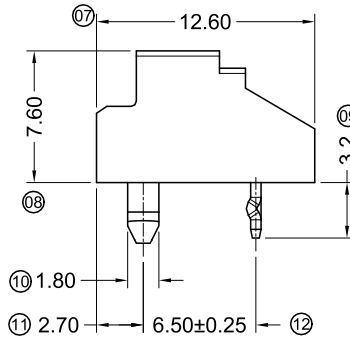
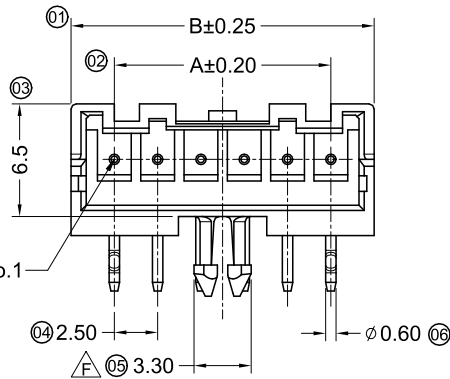
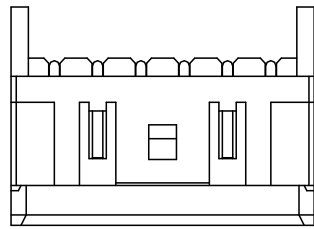

RECOMMENDED P.C.B LAYOUT T=1.60mm (TOLERANCE:±0.05)

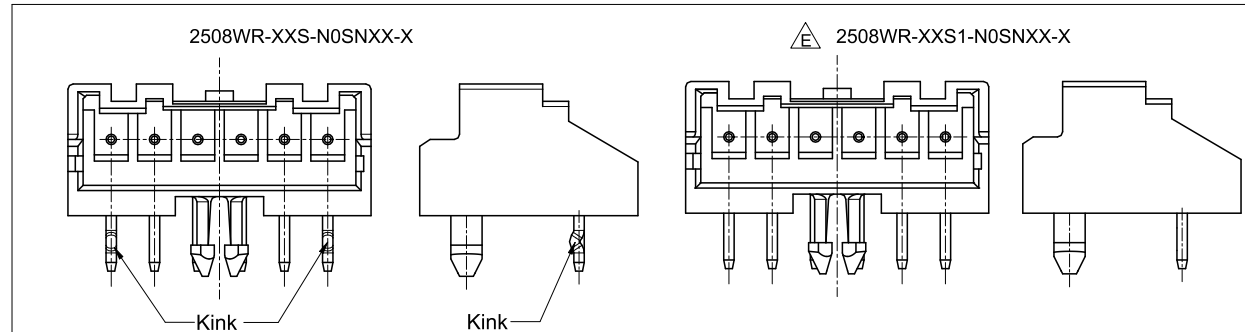

2021/05/06	F	EN120210506001	Modify the post structure and add new product type	Cai Zhao	John Yang	GENERAL TOLERANCE .X ±0.30 .XX ±0.20 .XXX ±0.10 X.° ±2° PROJECT	东莞市思索连接器有限公司 SWB CONNECTORS CO.,LTD				PART NO. 2508WR-XXX-N0SNXX-X								
2021/03/31	E	EN120210331001	Add the specification without kink and red	Xin Qing	John Yang						TITLE 2.50 mm Crimp Style connectors								
2020/10/10	D	ER120201010001	Remove matte tin plating code	TengMin	Harvey Yan						APPROVAL	CHECK	DRAWN	DATE	UNIT	SCALE	SHEET	REV	NUMBER
DATE	REV	ECN NO.	DESCRIPTION	MODIFY	APPROVAL						Smark	Guo	Alan qin	2017/11/21	mm	1:1	1/2	F	A-000

RoHS

This products can apply to the SWB Doc NO. QA-3-04-005 of Environmental&Material Management Rules

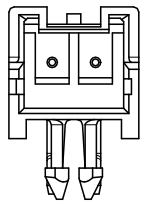

2Pin

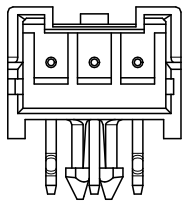

3Pin

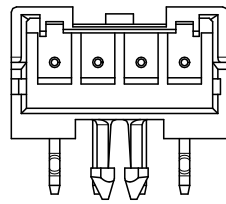

4Pin

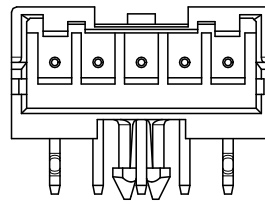

5Pin

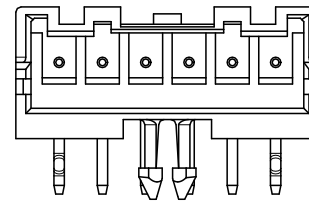

6Pin

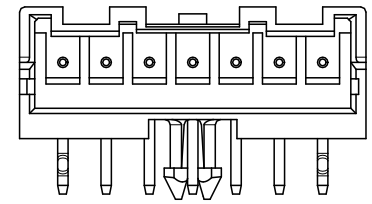

7Pin

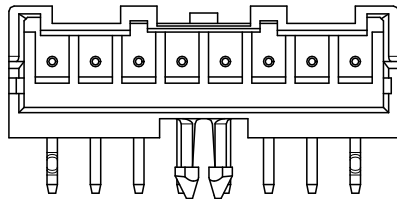

8Pin

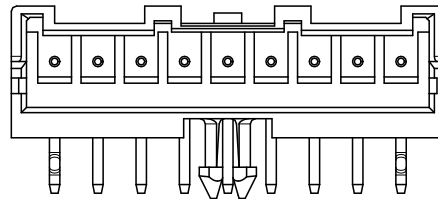

9Pin

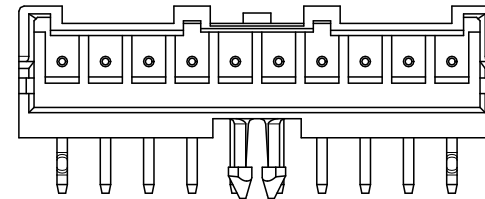

10Pin

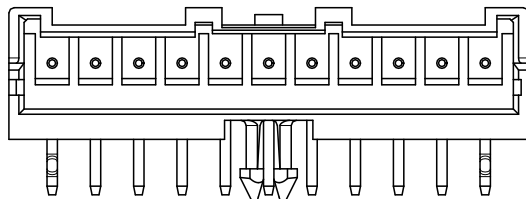

11Pin

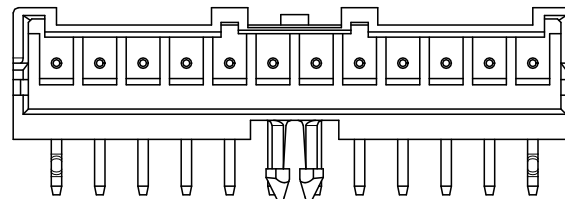

12Pin

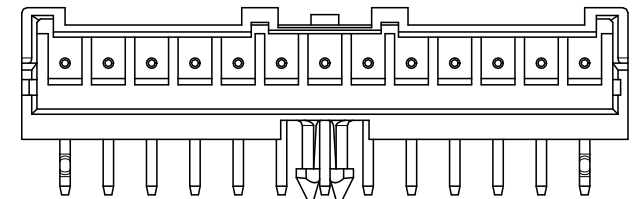

13Pin

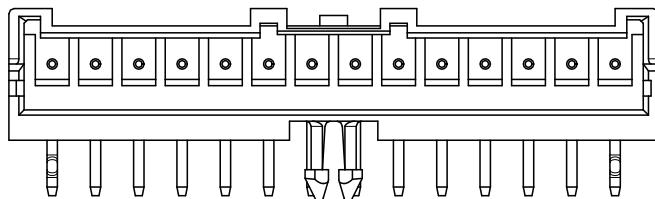

14Pin

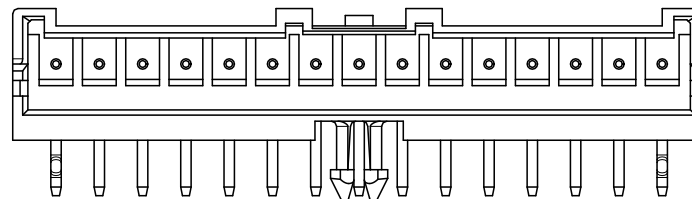

15Pin



2021/05/06	F	EN120210506001	Modify the post structure and add new product type	Cai Zhao	John Yang
2021/03/31	E	EN120210331001	Add the specification without kink and red	Xin Qing	John Yang
2020/10/10	D	ER120201010001	Remove matte tin plating code	TengMin	Harvey Yan
DATE	REV	ECN NO.	DESCRIPTION	MODIFY	APPROVAL

GENERAL TOLERANCE
.X ±0.30
.XX ±0.20
.XXX ±0.10
X.° ±2°
PROJECT

东莞市思索连接器有限公司
SWB CONNECTORS CO.,LTD

APPROVAL	CHECK	DRAWN	DATE
Smark	Guo	Alan qin	2017/11/21

PART NO. 2508WR-XXX-N0SNXX-X				
TITLE 2.50 mm Crimp Style connectors				
UNIT	SCALE	SHEET	REV	NUMBER
mm	1:1	2/2	F	A-000

F
E
D
C
B
A

F
E
D
C
B
A

1 | 2 | 3 | 4 | 5 | 6 | 7 | 8

1 | 2 | 3 | 4 | 5 | 6 | 7 | 8

RoHS

This products can apply to the SWB Doc NO. QA-3-04-005 of Environmental&Material Management Rules



Poles	Dimensions/mm			
	A	B	C	D
2	2.50	5.75	10.00	4.05
3	5.00	8.25	12.50	7.00
4	7.50	10.75	15.00	9.20
5	10.00	13.25	17.50	11.35
6	12.50	15.75	20.00	13.85
7	15.00	18.25	22.50	16.35
8	17.50	20.75	25.00	18.85
9	20.00	23.25	27.50	21.35
10	22.50	25.75	30.00	23.85
11	25.00	28.25	32.50	26.35
12	27.50	30.75	35.00	28.85
13	30.00	33.25	37.50	31.35
14	32.50	35.75	40.00	33.85
15	35.00	38.25	42.50	36.35

Specifications:

- Voltage Rating: 250V AC/DC
- Current Rating: 3A AC/DC
- Withstanding Voltage: 1000V AC/Minute
- Temperature Range: -40°C~+125°C
- Insulation Resistance: 100MΩ Min./500V DC/Minute
- Contact Resistance: ≤10mΩ (Initial)
≤20mΩ (After Testing)
- Mates With Housing: 2508H-XX, 2513H-XX
- Product Specification: PS-2513-02
- Packaging Drawing: PK-2508WVS-XXE-9TXNX
- Symbols for SPC Dimensions: "★"

2508 W V S-XX E-9T X N X
① ② ③ ④ ⑤ ⑥ ⑦ ⑧ ⑨ ⑩

- ① Series No.: 2508
- ② Category: W-Wafer
- ③ Connector Type: V-Straight 180°
- ④ Mounting Type: S-SMT
- ⑤ Row No.-Pin No.:
XX-Single Row-02Pin~15Pin
- ⑥ Special No.: E-Stamping Terminal
- ⑦ Plastic Material: 9T-PA9T (UL94V-0)
- ⑧ Planting Code: SW1-Matte Tin
Underplate: Ni 40~120u"(1~3um) overall
Top Plating: Sn 80~200u"(2~5um) overall
- △ GW01-Underplate: Ni 40~120u"(1~3um) overall
Contact area Plating Au 1U"(0.025um)Min
Weld area Plating Sn 80~200u"(2~5um)
- ⑨ Color: N-Natural
- ⑩ Packing: X-R: Reel ; C: With Cap

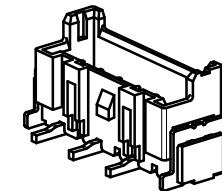
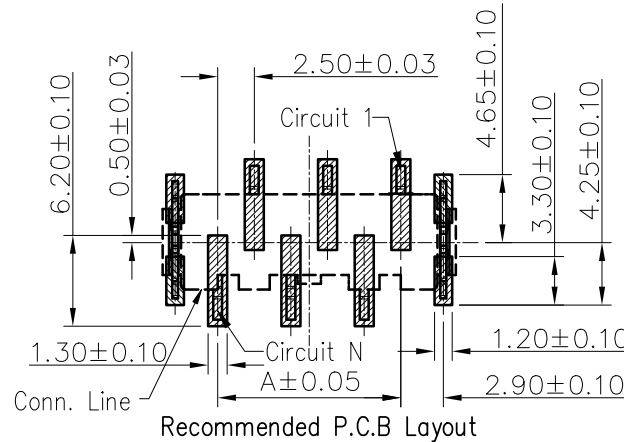
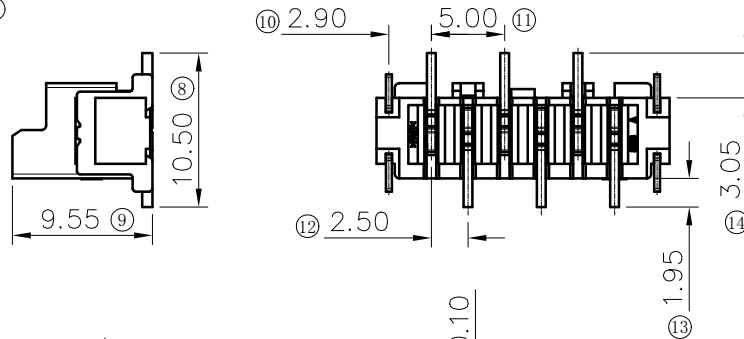
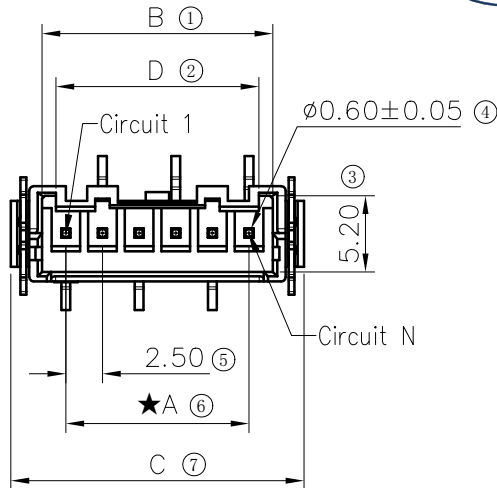
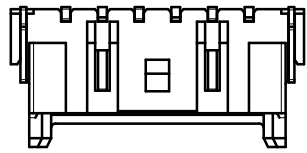

Without Cap

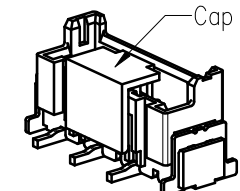

With Cap

202200708	B1	ER20220708001	Update the 4Pin view	Zeng	Larry
20210415	B	EN120210415001	Add the Planting Code GW01	Cai Zhao	John Yang
20210312	A	/	Initial release	Cai Zhao	John Yang
DATE	REV	ECN NO.	DESCRIPTION	MODIFY	APPROVAL

GENERAL TOLERANCE	
.X	±0.35
.XX	±0.25
.XXX	±0.15
X.°	±2°
PROJECT	
⊕	□



东莞市思索连接器有限公司
SWB CONNECTORS CO.,LTD

APPROVAL	CHECK	DRAWN	DATE
Kevin	John Yang	Cai Zhao	2021/03/12

PART NO.				
2508WVS-XXE-9TXNX				
TITLE				
2.50mm WF ASSY vertical SMT				
UNIT	SCALE	SHEET	REV	NUMBER
mm	2:1	1/2	B1	A-000

RD-1

F

E

D

C

B

A

RoHS

This products can apply to the SWB Doc NO. QA-3-04-005 of Environmental&Material Management Rules

RD-1

02 Pin

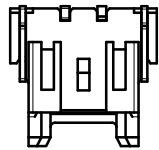

03 Pin

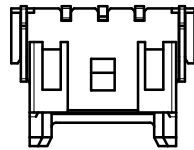

04 Pin

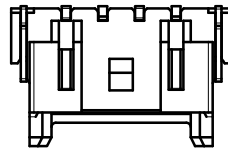

05 Pin

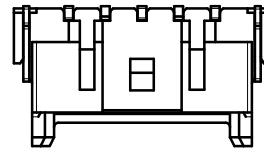

06~15 Pin

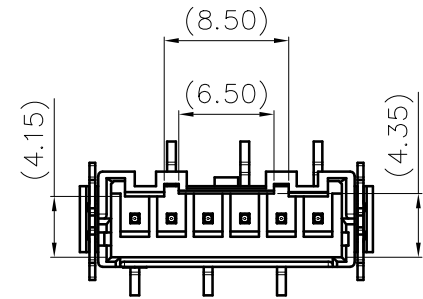
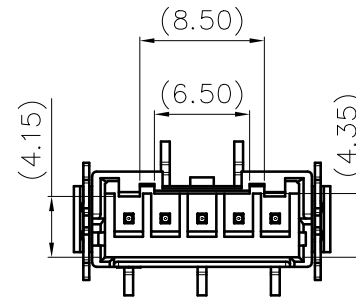
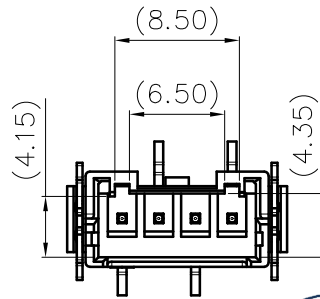
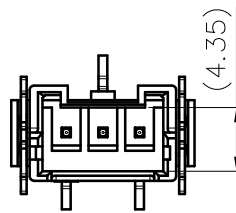
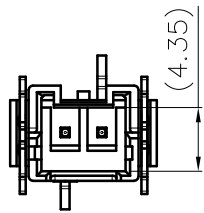
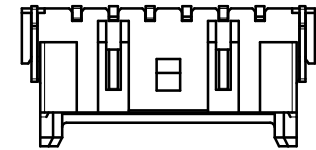

202200708	B1	ER20220708001	Update the 4Pin view	Zeng	Larry	GENERAL TOLERANCE .X ±0.35 .XX ±0.25 .XXX ±0.15 X° ±2° PROJECT 	东莞市思索连接器有限公司 SWB CONNECTORS CO.,LTD				PART NO. 2508WVS-XXE-9TXNX				
20210415	B	EN120210415001	Add the Planting Code GW01	Cai Zhao	John Yang						APPROVAL				TITLE 2.50mm WF ASSY vertical SMT
20210312	A	/	Initial release	Cai Zhao	John Yang		Kevin	John Yang	Cai Zhao	2021/03/12	UNIT	SCALE	SHEET	REV	NUMBER
DATE	REV	ECN NO.	DESCRIPTION	MODIFY	APPROVAL						mm	2:1	2/2	B1	A-000

RoHS

This products can apply to the SWB Doc NO. QA-3-04-005 of Environmental&Material Management Rules

RD-1

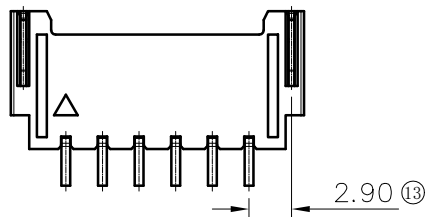
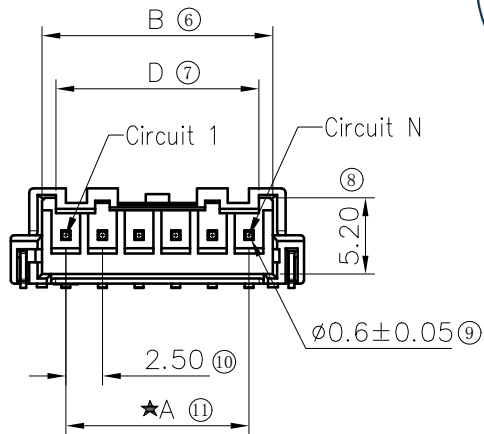
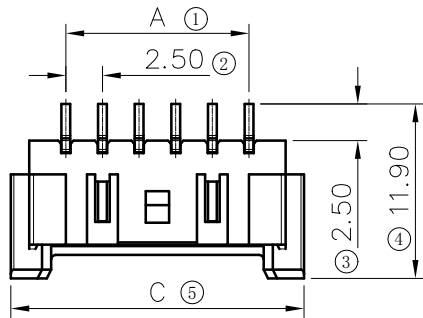

Poles	Dimensions/mm			
	A	B	C	D
2	2.50	5.75	10.00	4.05
3	5.00	8.25	12.50	7.00
4	7.50	10.75	15.00	9.20
5	10.00	13.25	17.50	11.35
6	12.50	15.75	20.00	13.85
7	15.00	18.25	22.50	16.35
8	17.50	20.75	25.00	18.85
9	20.00	23.25	27.50	21.35
10	22.50	25.75	30.00	23.85
11	25.00	28.25	32.50	26.35
12	27.50	30.75	35.00	28.85
13	30.00	33.25	37.50	31.35
14	32.50	35.75	40.00	33.85
15	35.00	38.25	42.50	36.35

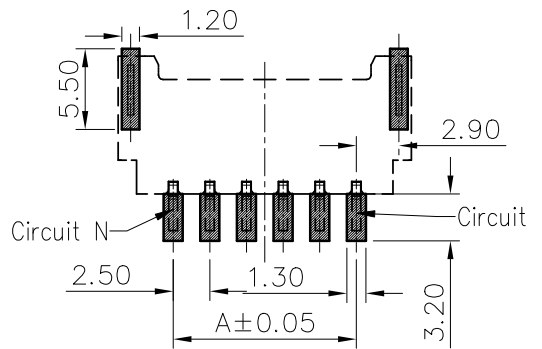
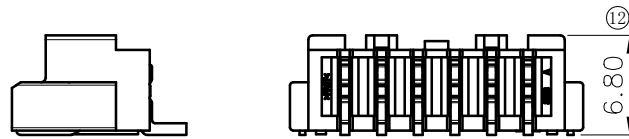

Recommended P.C.B Layout

Specifications:

- Voltage Rating: 250V AC/DC
- Current Rating: 3A AC/DC
- Withstanding Voltage: 1000V AC/Minute
- Temperature Range: -40°C~+125°C
- Insulation Resistance: 100MΩ Min./500V DC/Minute
- Contact Resistance: $\leq 10m\Omega$ (Initial)
$\leq 20m\Omega$ (After Testing)
- Mates With Housing: 2508H-XX, 2513H-XX
- Product Specification: PS-2513-02
- Packaging Drawing: PK-2508WRS-XXE-9TXNR
- Symbols for SPC Dimensions: "★"

2508 WRS-XXE-9TXNR
① ②③④ ⑤ ⑥ ⑦ ⑧ ⑨ ⑩

- ① Series No.: 2508
- ② Category: W-Wafer
- ③ Connector Type: R-Right Angle 90°
- ④ Mounting Type: S-SMT
- ⑤ Row No.-Pin No.:
XX-Single Row-02Pin~15Pin
- ⑥ Special No.: E-Stamping Terminal
- ⑦ Plastic Material: 9T-PA9T (UL94V-0)
- ⑧ Planting Code: SW1-Matte Tin
Underplate: Ni 40~120u"(1~3um) overall
Top Plating: Sn 80~200u"(2~5um) overall
- △ GW01-Underplate: Ni 40~120u"(1~3um) overall
Contact area Plating Au 1U"(0.025um)Min
Weld area Plating Sn 80~200u"(2~5um)
- ⑨ Color: N-Natural
- ⑩ Packing: R-Reel

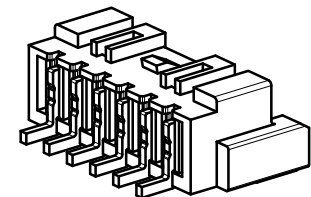

					GENERAL TOLERANCE				PART NO.								
A	20210415	B	EN120210415001	Add the Planting Code GW01	Cai Zhao	John Yang	.X	±0.35	2508WRS-XXE-9TXNX								
	20210312	A	/	Initial release	Cai Zhao	John Yang	.XX	±0.25	TITLE 2.50mm WF								
	DATE	REV	ECN NO.	DESCRIPTION	MODIFY	APPROVAL	.XXX	±0.15	ASSY right-angle SMT								
					PROJECT				APPROVAL	CHECK	DRAWN	DATE					
					APPROVAL				Kevin	John Yang	Cai Zhao	2021/03/12	UNIT	SCALE	SHEET	REV	NUMBER
					APPROVAL				mm	2:1	1/2	B	A-000				



东莞市思索连接器有限公司
SWB CONNECTORS CO.,LTD

UNIT	SCALE	SHEET	REV	NUMBER
mm	2:1	1/2	B	A-000

RoHS

This products can apply to the SWB Doc NO. QA-3-04-005 of Environmental&Material Management Rules

RD-1

02 Pin

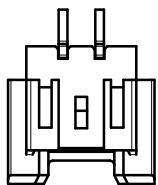

03 Pin

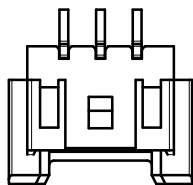

04 Pin

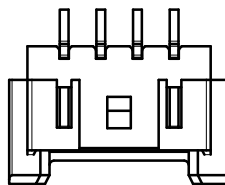

05 Pin

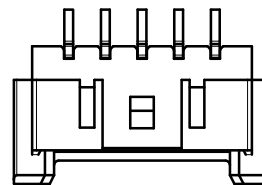

06~15 Pin

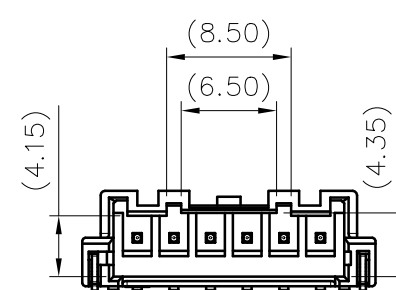
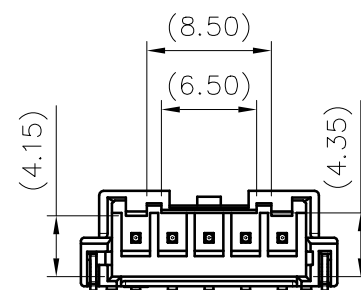
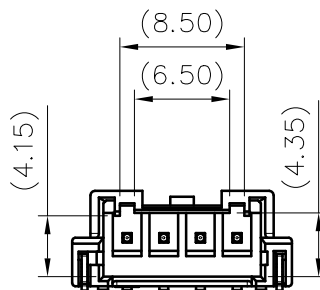
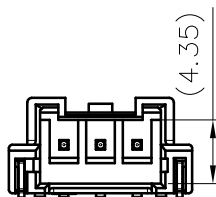
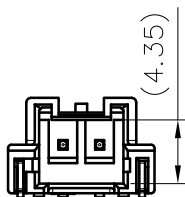
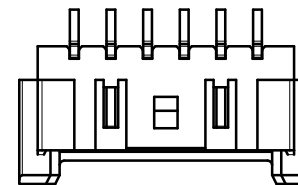

A	20210415	B	EN120210415001	Add the Planting Code GW01	Cai Zhao	John Yang	东莞市思索连接器有限公司 SWB CONNECTORS CO.,LTD				PART NO. 2508WRS-XXE-9TXNX					
	20210312	A	/	Initial release	Cai Zhao	John Yang					TITLE 2.50mm WF ASSY right-angle SMT					
	DATE	REV	ECN NO.	DESCRIPTION	MODIFY	APPROVAL	PROJECT	APPROVAL	CHECK	DRAWN	DATE	UNIT	SCALE	SHEET	REV	NUMBER
							Kevin John Yang Cai Zhao 2021/03/12	Kevin	John Yang	Cai Zhao	2021/03/12	mm	2:1	2/2	B	A-000