

RoHS

This products can apply to the SESO Doc NO. QA-3-04-005 of Environmental&Material Management Rules

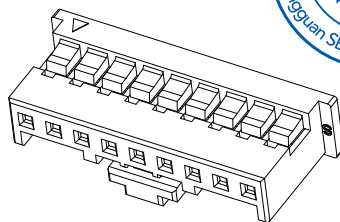
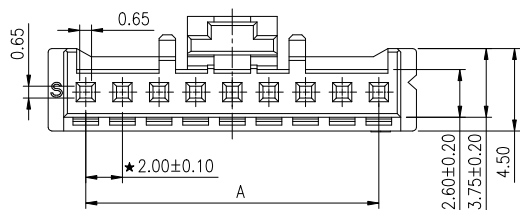

Specifications :

- Voltage rating: 250V AC / DC
- Current rating: 3A AC / DC
- Withstanding voltage: 500V AC/minute
- Temperature range: -40°C~+105°C
- Insulation resistance: ≥1000MΩ
- Contact resistance: <10mΩ
- After environmental testing: <20mΩ
- Mates with SESO Header: 2000 Series
- "★" Critical dimension

2020 H X - 1 x XX - NO N B R 01 Q
 ① ② ③ ④ ⑤ ⑥ ⑦ ⑧ ⑨ ⑩

- ① Series No.
- ② Category: H-Housing
- ③ Connector Type: Blank- Common
- ④ Row No.-Pin No: 1xXX-Single Row 1xXXPin
- ⑤ Plastic material: NO-PA66 UL94V-0
- ⑥ Color: N-Natural; B-Black; R-Red; L-Blue
- ⑦ Packing: B-Bag
- ⑧ RoHS/HF Code: R-RoHS Compliant
- ⑨ Sequence Number: 01
- ⑩ Special code: Q-Automotive Connectors

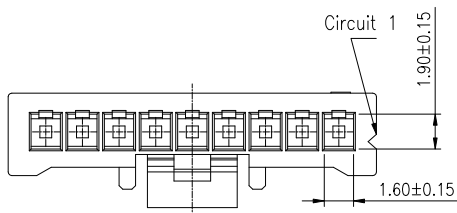
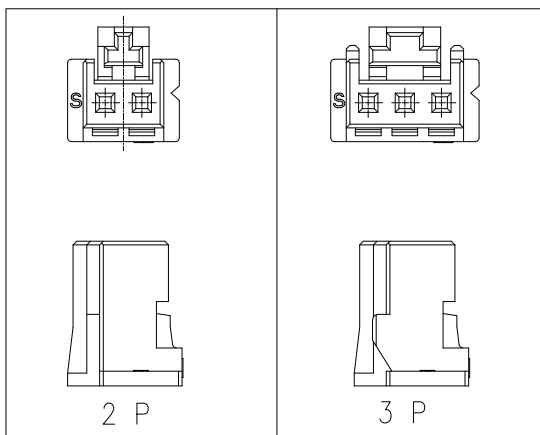
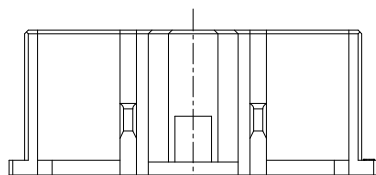
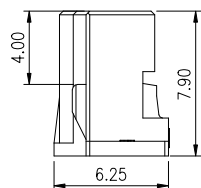
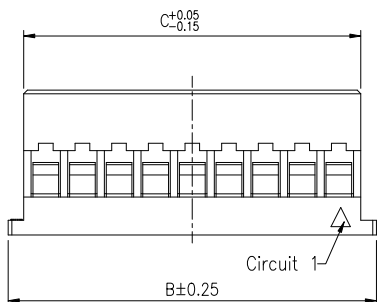

Pin 位	尺寸 (mm)			Pin 位	尺寸 (mm)		
	A	B	C		A	B	C
2	2.00	6.10	4.40	10	18.00	22.10	20.40
3	4.00	8.10	6.40	11	20.00	24.10	22.40
4	6.00	10.10	8.40	12	22.00	26.10	24.40
5	8.00	12.10	10.40	13	24.00	28.10	26.40
6	10.00	14.10	12.40	14	26.00	30.10	28.40
7	12.00	16.10	14.40	15	28.00	32.10	30.40
8	14.00	18.10	16.40				
9	16.00	20.10	18.40				

20231104	B1	/	Update surface	Wangcheng	Larry Yang
20190928	B	/	Update tolerance	Larry Yang	Harvey Yan
20190920	A	/	Initial release	Larry Yang	Harvey Yan
DATE	REV	ECN NO.	DESCRIPTION	MODIFY	APPROVAL

GENERAL TOLERANCE	
.X	±0.30
.XX	±0.20
.XXX	±0.10
X.' ±Z'	
PROJECT	

SMS 东莞市思索技术股份有限公司
 Dongguan SESO Technology Co.,Ltd.

APPROVAL	CHECK	DRAWN	DATE
Kim Huang	Harvey Yan	Larry Yang	2019/09/20

PART NO. 2020H-1xXX-NOXBRO1Q				
TITLE 2.00mm Connector Housing				
UNIT	SCALE	SHEET	REV	NUMBER
mm	1:1	1/1	B1	CD

RoHS

This products can apply to the SESO Doc NO. QA-3-04-005 of Environmental&Material Management Rules

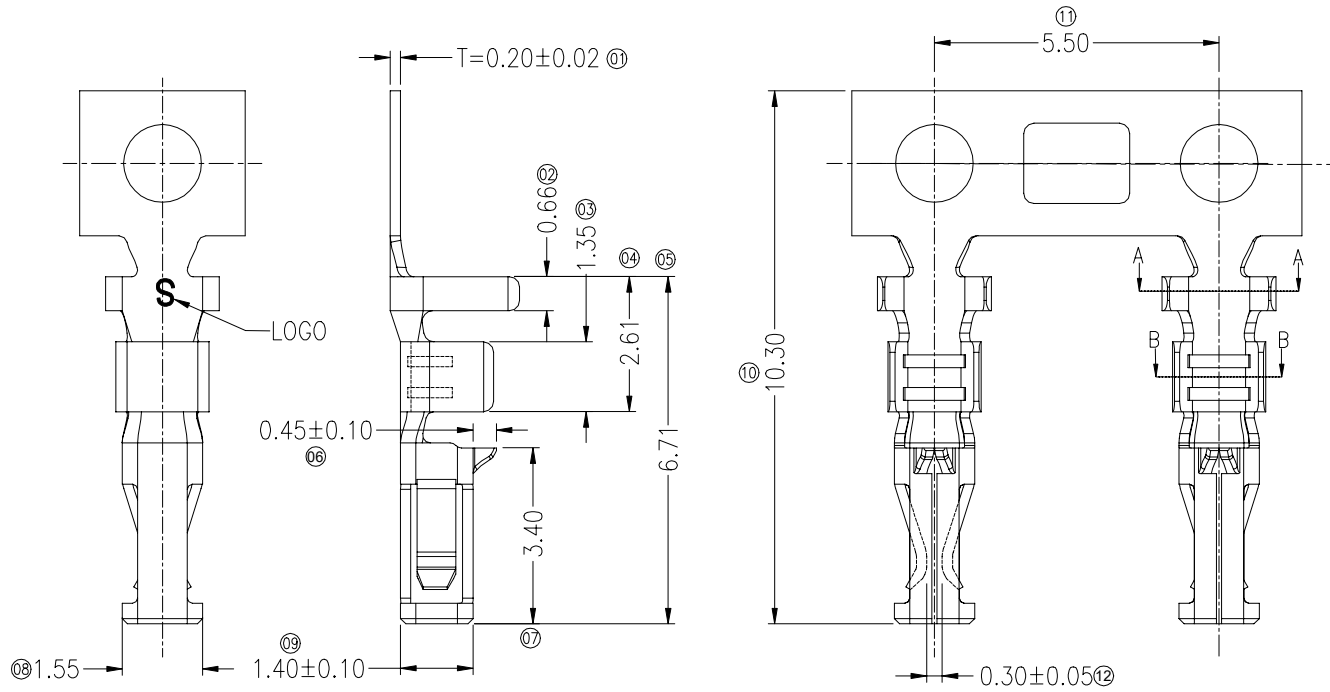

- Specifications :
- Voltage rating: 250V AC / DC
 - Current rating: 3A AC / DC
 - Withstanding voltage: 500V AC/minute
 - Temperature range: -40°C~+105°C
 - Insulation resistance: >1000MΩ
 - Contact resistance: <10mΩ
 - After environmental testing: <20mΩ
 - Used In SESO Housing: 2020H

2020 T X -P 08 S-01 Q
 ① ② ③ ④ ⑤ ⑥ ⑦ ⑧

- ① Series No.
- ② Category: T-Terminal
- ③ Shape: Blank-ordinary ; L- Lower
- ④ Material: P-Phosphor bronze
- ⑤ Plating Style: 08-See table 1
- ⑥ Plating Method : S-Stamping before Plating
- ⑦ Sequence Number: 01
- ⑧ Special code:Q-Automotive Connectors

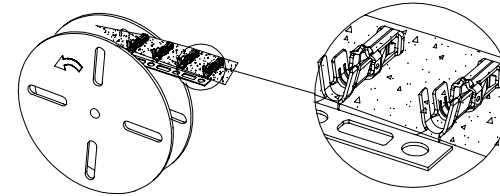
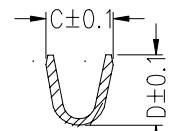
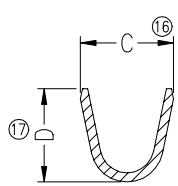
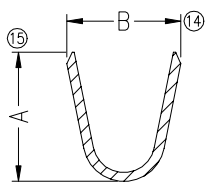

User direction of unreeling



2020TL-P08S-01Q (低脚)	Phosphor bronze	AWG#24~26 (0.22~0.13mm ²) 1.30mm(Max)	2.50	2.20	1.30	1.40	Ni:40u~120" (1-3um)overall Tin:80~200u"(2~5um)overall
2020T-P08S-01Q (普通脚)	Phosphor bronze	AWG#20~22 (0.5~0.35mm ²) 1.60mm(Max)	2.50	2.20	1.80	1.80	Ni:40u~120" (1-3um)overall Tin:80~200u"(2~5um)overall
P/N	Material	Wire Size	Dim A	Dim B	Dim C	Dim D	Finish

GENERAL TOLERANCE	
.X	±0.30
.XX	±0.20
.XXX	±0.10
X.' ±2"	
PROJECT	

SMS 东莞市思索技术股份有限公司
Dongguan SESO Technology Co.,Ltd.

PART NO. 2020TX-P08S-01Q

APPROVAL CHECK DRAWN DATE

TITLE 2.00mm Crimp Style Terminal

Kim Huang Harvey Yan Larry Yang 2019/09/20

UNIT	SCALE	SHEET	REV	NUMBER
mm	7:1	1/1	A	XXXX

DATE	REV	ECN NO.	DESCRIPTION	MODIFY	APPROVAL
1					

RoHS

This products can apply to the SESO Doc NO. QA-3-04-005 of Environmental&Material Management Rules

RD-1

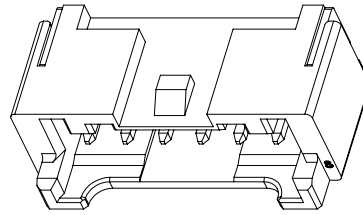
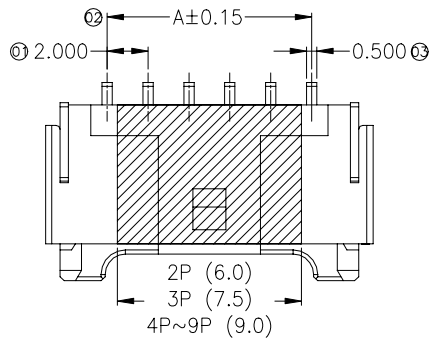

Specifications :

- Voltage rating: 250V AC / DC
- Current rating: 3A AC / DC
- Withstanding voltage: 800V AC/minute
- Temperature range: -40°C~+125°C
- Insulation resistance: ≥1000MΩ
- Contact resistance: ≤10mΩ
- After environmental testing: ≤20mΩ
- Material(Pin): Brass
- Material(Solder Tabs): Brass
- Mates With SESO Housing 2000H

P/N system:

2000 W R S-XX X-XX SW XX X XX
① ② ③ ④ ⑤ ⑥ ⑦ ⑧ ⑨ ⑩ ⑪

- ① Series No.
- ② Category: W-WAFER
- ③ Connector type: R-Right Angle 90°
- ④ Mouting type: S-SMT
- ⑤ Row No.-Pin No per row: XX-02P~16P
- ⑥ Special No.
- ⑦ Material: 9T-PA9T 94V-0; LP-LCP 94V-0
- ⑧ Plating code: SW-Matte Tin GW3-Contact point gold 3u"
- ⑨ Color : Blank-Natural Color ; BK-Black Color
- ⑩ Packing: Blank-Reel ,With Mylar
R-Reel ,Without Mylar
- ⑪ Cover tape type: Blank-Adhesive ; RQ-Heat sealing

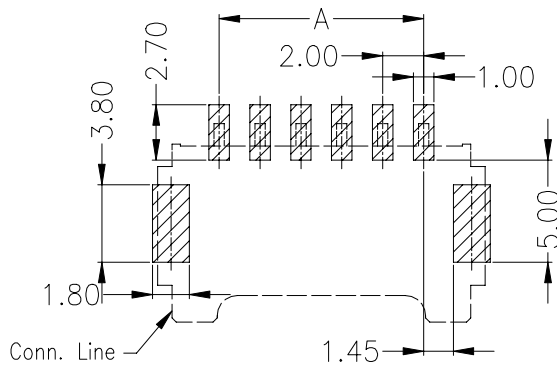
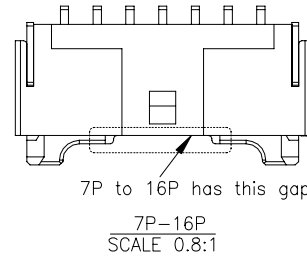
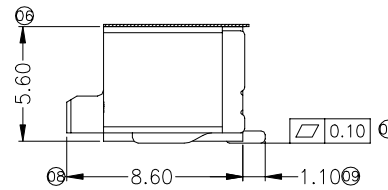
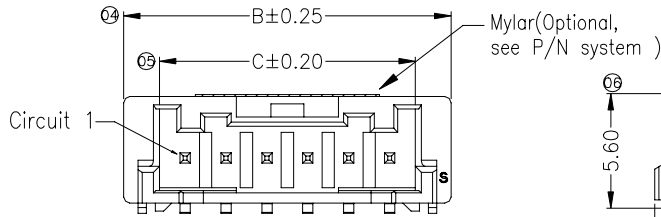

Recommended P.C.B Layout
General Tolerance±0.05

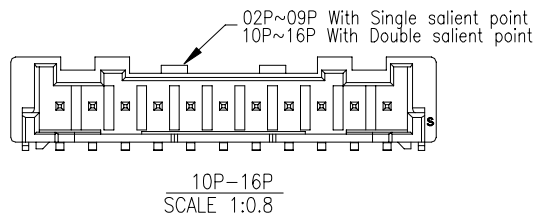
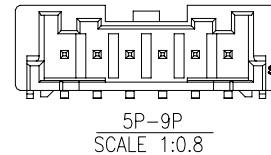
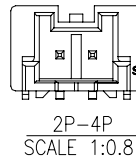

Poles	Dimensions (mm)			Poles	Dimensions (mm)		
	A	B	C		A	B	C
02	2.00	8.00	4.50	10	18.00	24.00	20.50
03	4.00	10.00	6.50	11	20.00	26.00	22.50
04	6.00	12.00	8.50	12	22.00	28.00	24.50
05	8.00	14.00	10.50	13	24.00	30.00	26.50
06	10.00	16.00	12.50	14	26.00	32.00	28.50
07	12.00	18.00	14.50	15	28.00	34.00	30.50
08	14.00	20.00	16.50	16	30.00	36.00	32.50
09	16.00	22.00	18.50				

DATE	REV	ECN NO	DESCRIPTION	MODIFY	APPROVAL
2023/06/14	N1		Update Drawing Frame	LXZ	Larry Yang
2022/09/09	N		Added half gold plated 3U "specification	Xuexiaolong	Larry
2020/09/23	M	EN120200923001	Add P/N for heat sealing cover tape	TengMin	Harvey Yan

GENERAL TOLERANCE	
.X	±0.30
.XX	±0.20
.XXX	±0.10
X.°	±2°
PROJECT	
①	②

SMS 东莞市思索技术股份有限公司
Dongguan SESO Technology Co.,Ltd.

APPROVAL	CHECK	DRAWN	DATE
Jack Zhang	Larry Yang	Alan qin	2014/05/05

PART NO.				
2000WRS-XX-XXSWXXX				
TITLE				
2.00mm Crimp Style Connector				
UNIT	SCALE	SHEET	REV	NUMBER
mm	3:1	1/1	N1	A-000

RoHS

This products can apply to the SESO Doc NO. QA-3-04-005 of Environmental&Material Management Rules

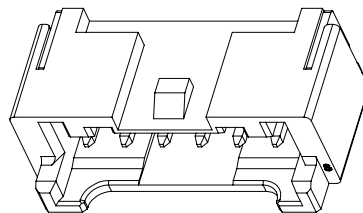
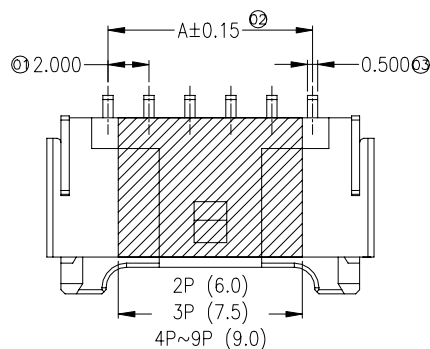

Specifications :

- Voltage rating: 250V AC / DC
- Current rating: 3A AC / DC
- Withstanding voltage: 800V AC/minute
- Temperature range: -40°C~+125°C
- Insulation resistance: >1000MΩ
- Contact resistance: <10mΩ
- After environmental testing: <20mΩ
- "★" Critical dimension
- Material(Pin): Brass
- Material(Solder Tabs): Brass
- Mates With SESO Housing: 2000H

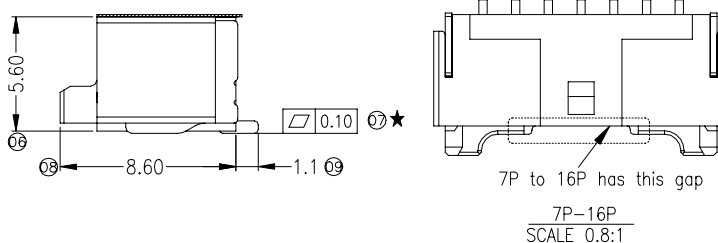
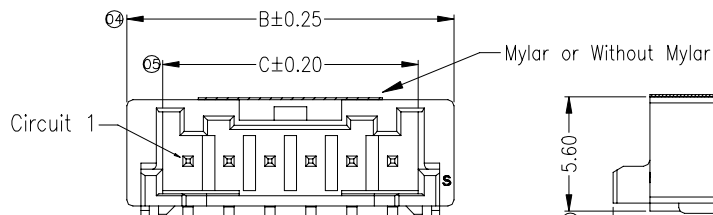

2000 W R S-XX X-XX SWXX X-S
① ② ③ ④ ⑤ ⑥ ⑦ ⑧ ⑨ ⑩

- ① Series No.
- ② Category: W-WAFER
- ③ Connector type: R-Right Angle 90°
- ④ Mounting type: S-SMT
- ⑤ Row No.-Pin No per row: XX=02P~16P
- ⑥ Special No.
- ⑦ Material: 9T -PA9T 94V-0; LP -LCP 94V-0
- ⑧ Plating code: SW- Matte Tin GW3-Contact point gold 3u"
- ⑨ Color : Blank-Natural Color ; BK-Black Color
- ⑩ Packing: Blank-Reel ,02~09P With Mylar;
10~16P Without Mylar
R-Reel ,02~09P Without Mylar

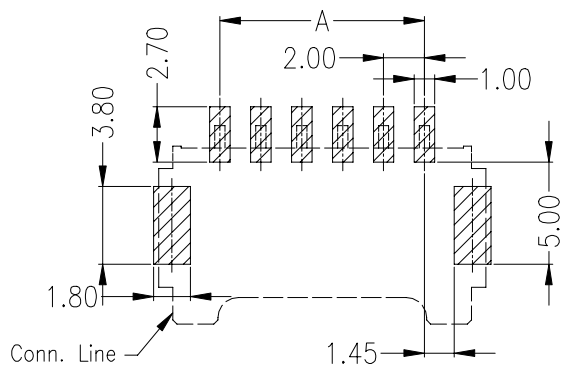

Recommended P.C.B Layout
General Tolerance±0.05

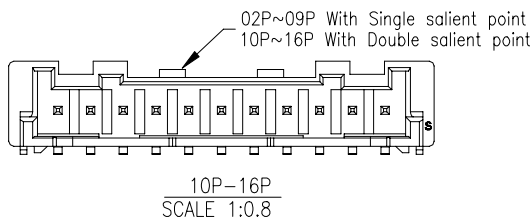
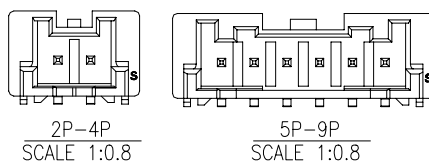

Poles	Dimensions (mm)			Poles	Dimensions (mm)		
	A	B	C		A	B	C
02	2.00	8.00	4.50	10	18.00	24.00	20.50
03	4.00	10.00	6.50	11	20.00	26.00	22.50
04	6.00	12.00	8.50	12	22.00	28.00	24.50
05	8.00	14.00	10.50	13	24.00	30.00	26.50
06	10.00	16.00	12.50	14	26.00	32.00	28.50
07	12.00	18.00	14.50	15	28.00	34.00	30.50
08	14.00	20.00	16.50	16	30.00	36.00	32.50
09	16.00	22.00	18.50				

DATE	REV	ECN NO.	DESCRIPTION	MODIFY	APPROVAL	PROJECT
2023/06/14	M1		Update Drawing Frame	LXZ	Larry Yang	GENERAL TOLERANCE
2022/09/09	M		Added half gold plated 3U "specification	xuexiaolong	Larry	.X ±0.30
2020/03/20	L	EN20200319001	Update Drawing Frame	Wzbin	Robing	.XX ±0.20
						.XXX±0.10
						X.' ±2'

APPROVAL	CHECK	DRAWN	DATE
Jack Zhang	Larry Yang	Alan qin	2014/05/05

PART NO.				
2000WRS-XX-XXSWXXX-S				
TITLE				
2.00mm Crimp Style Connector				
UNIT	SCALE	SHEET	REV	NUMBER
mm	1:1	1/1	M1	A-000

RoHS

This products can apply to the SESO Doc NO. QA-3-04-005 of Environmental&Material Management Rules

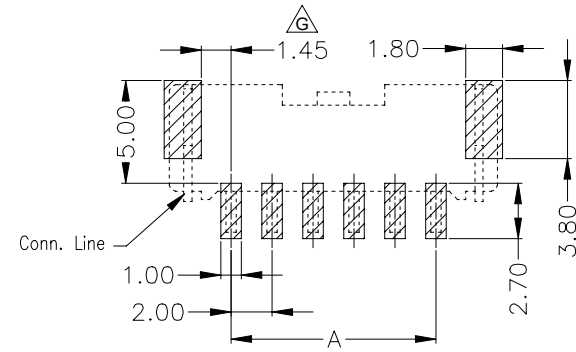
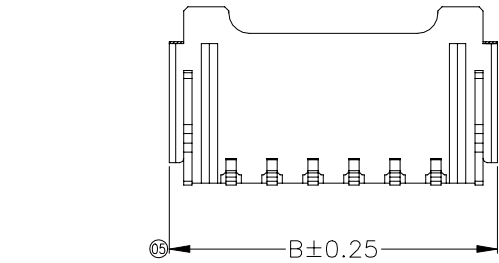
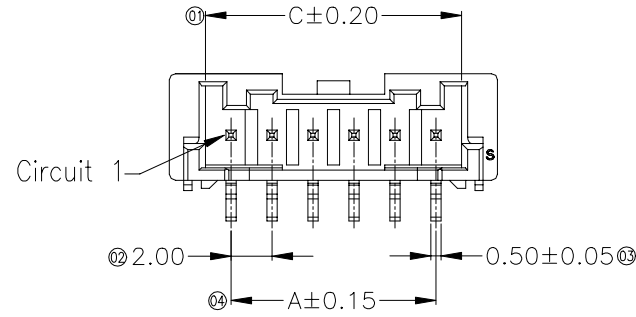

Recommended P.C.B Layout
General Tolerance±0.05

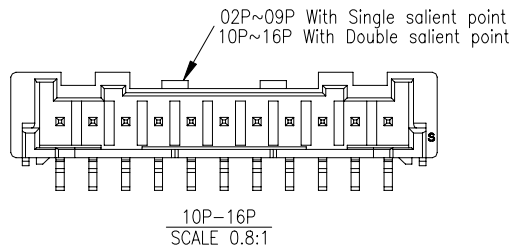
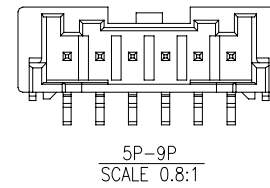
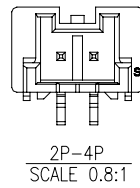
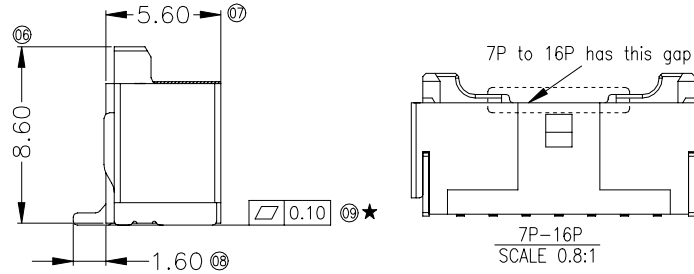
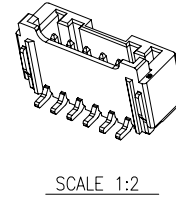
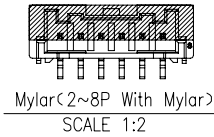
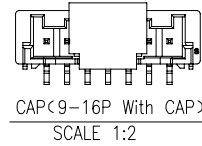

Specifications :

- Voltage rating: 250V AC / DC
- Current rating: 3A AC / DC
- Withstanding voltage: 800V AC/minute
- Temperature range: -40°C~+125°C
- Insulation resistance: ≥1000MΩ
- Contact resistance: <10mΩ
- After environmental testing: <20mΩ
- Material(Pin): Brass
- Material(Solder Tabs): Brass
- Mates With SESO Housing: 2000H
- "★" Critical dimension

2000 W V S-XX X-9T SW XX X-S
① ② ③ ④ ⑤ ⑥ ⑦ ⑧ ⑨ ⑩ ⑪

- ① Series No.
- ② Category: W-WAFER
- ③ Connector type: V-Stright 180°
- ④ Mouting type: S-SMT
- ⑤ Pin number: XX-02P~16P
- ⑥ Plug the Pin & Special No.
Blank-With Mylar C- With CAP
- ⑦ Material: 9T -PA9T 94V-0
- ⑧ Plating Code: SW-Matte Tin
- ⑨ Color : Blank-Natural ; BK-Black
- ⑩ Packing: Blank-Reel ,2~8P With Mylar
9-16P With CAP
R-Reel ,Without Mylar&CAP

⑪ Special NO:S

Poles	Dimensions (mm)			Poles	Dimensions (mm)		
	A	B	C		A	B	C
02	2.00	8.00	4.50	10	18.00	24.00	20.50
03	4.00	10.00	6.50	11	20.00	26.00	22.50
04	6.00	12.00	8.50	12	22.00	28.00	24.50
05	8.00	14.00	10.50	13	24.00	30.00	26.50
06	10.00	16.00	12.50	14	26.00	32.00	28.50
07	12.00	18.00	14.50	15	28.00	34.00	30.50
08	14.00	20.00	16.50	16	30.00	36.00	32.50
09	16.00	22.00	18.50				

2023/06/14	J1		Update Drawing Frame	lxz	Larry Yang	东莞市思索技术股份有限公司 Dongguan SESO Technology Co.,Ltd.				PART NO. 2000WVS-XXX-9TSWXXX-S					
2022/02/21	J	EN20211006001	Change the suction cover structure	Xue	John Yang					TITLE 2.00mm Crimp Style Connector					
2020/03/19	I	EN20200319001	Update Drawing Frame	Wzbin	Robing					APPROVAL	CHECK	DRAWN	DATE	UNIT SCALE SHEET REV NUMBER	
DATE	REV	ECN NO.	DESCRIPTION	MODIFY	APPROVAL					Jack Zhang	Larry Yang	Xue	2018/05/31	mm	1:1

RoHS

This products can apply to the SESO Doc NO. QA-3-04-005 of Environmental&Material Management Rules

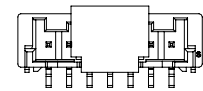
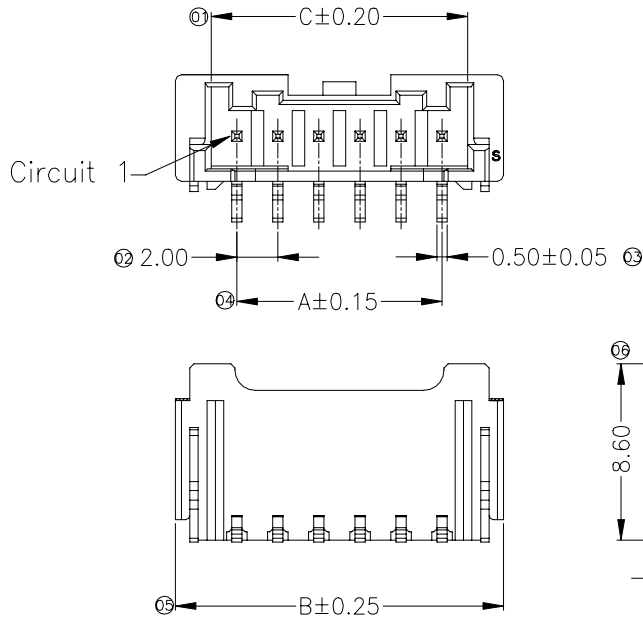

CAP(9-16P With CAP)
SCALE 1:2



Mylar(2~8P With Mylar)
SCALE 1:2

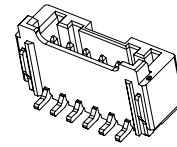

SCALE 1:2

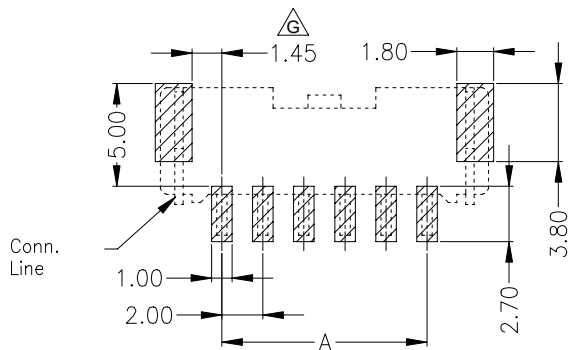
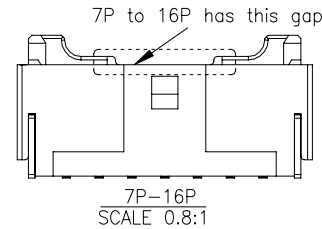
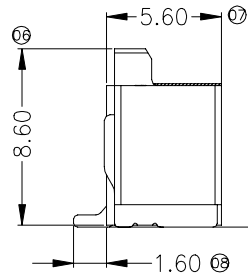

Recommended P.C.B Layout
General Tolerance±0.05

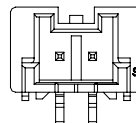

2P-4P
SCALE 0.8:1

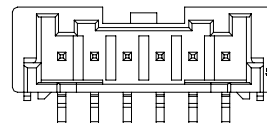

5P-9P
SCALE 0.8:1

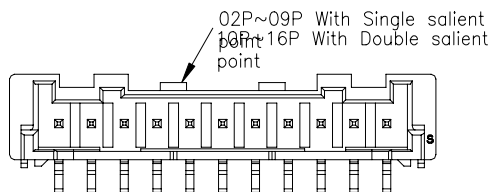

10P-16P
SCALE 0.8:1

Specifications :

- Voltage rating: 250V AC / DC
- Current rating: 3A AC / DC
- Withstanding voltage: 800V AC/minute
- Temperature range: -40°C~+125°C
- Insulation resistance: ≥1000MΩ
- Contact resistance: ≤10mΩ
- After environmental testing: ≤20mΩ
- Material(Pin): Brass
- Material(Solder Tabs): Brass
- Mates With SESO Housing: 2000H
- "★" Critical dimension

2000 W V S-XX X -9T SW XX X XX

① ② ③ ④ ⑤ ⑥ ⑦ ⑧ ⑨ ⑩ ⑪

- ① Series No.
- ② Category: W-WAFER
- ③ Connector type: V-Stright 180°
- ④ Mouting type: S-SMT
- ⑤ Pin number: XX-02P~16P
- ⑥ Plug the Pin & Special No.:
Blank-With Mylar , C-9-16P With CAP
- ⑦ Material: 9T -PA9T 94V-0
LP -LCP 94V-0
- ⑧ Plating Code:SW-Matte Tin ; G03-Contact Area Gold 3u"
- ⑨ Color : Blank-Natural ; BK-Black
- ⑩ Packing: Blank-Reel ,2~8P With Mylar
R-Reel ,Without Mylar&CAP
- ⑪ Cover tape type: Blank-Adhesive ; RQ- Heat sealing



Poles	Dimensions (mm)			Poles	Dimensions (mm)		
	A	B	C		A	B	C
02	2.00	8.00	4.50	10	18.00	24.00	20.50
03	4.00	10.00	6.50	11	20.00	26.00	22.50
04	6.00	12.00	8.50	12	22.00	28.00	24.50
05	8.00	14.00	10.50	13	24.00	30.00	26.50
06	10.00	16.00	12.50	14	26.00	32.00	28.50
07	12.00	18.00	14.50	15	28.00	34.00	30.50
08	14.00	20.00	16.50	16	30.00	36.00	32.50
09	16.00	22.00	18.50				

2023/06/14	K1		Update Drawing Frame	lxz	Larry Yang
2022/02/21	K	EN20211006001	Change the suction cover structure	Xue	John Yang
2021/02/27	J	EN120210227001	Add P/N for heat sealing cover tape and plating code	TengMin	John Yang
DATE	REV	ECN NO	DESCRIPTION	MODIFY	APPROVAL

GENERAL TOLERANCE	
.X	±0.30
.XX	±0.20
.XXX	±0.10
X.°	±2°
PROJECT	
	Jack Zhang
	Larry Yang

SMS 东莞市思索技术股份有限公司
Dongguan SESO Technology Co.,Ltd.

APPROVAL	CHECK	DRAWN	DATE
Jack Zhang	Larry Yang	Alan qin	2018/05/31

PART NO. 2000WVS-XXX-9TSWXXXX				
TITLE 2.00mm Crimp Style Connector				
UNIT	SCALE	SHEET	REV	NUMBER
mm	1:1	1/1	K1	A-000