

RoHS

This products can apply to the SESO Doc NO. QA-3-04-005 of Environmental&Material Management Rules

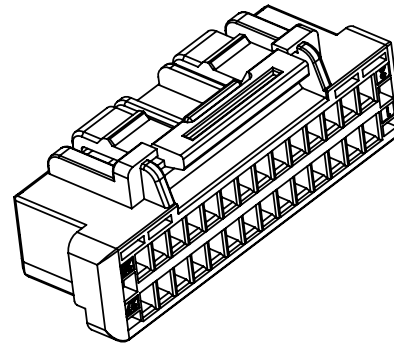
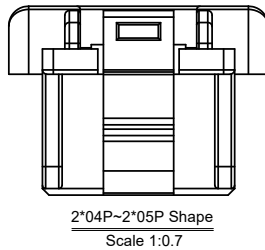
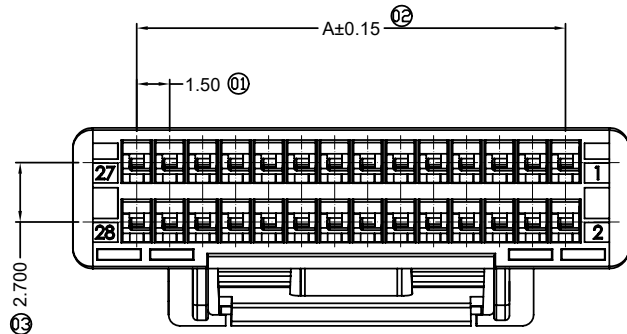

Specifications :

- Voltage rating: 100V AC / DC
- Current rating: 1.5A AC / DC
- Withstanding voltage: 500V AC/minute
- Temperature range: -40°C~+105°C
- Insulation resistance: ≥500MΩ
- Contact resistance: ≤20mΩ
- After environmental testing: ≤40mΩ
- Suitable SESOTerminal: 1515T

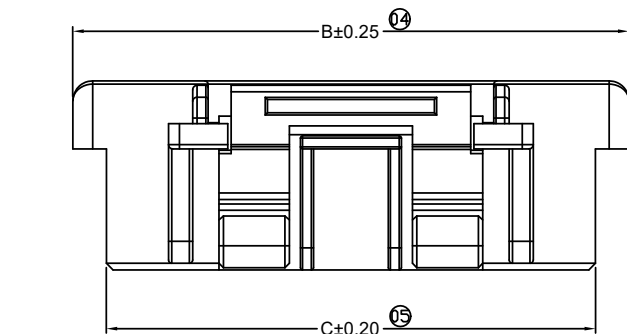

2\*06P~2\*14P Shape  
Scale 1:1

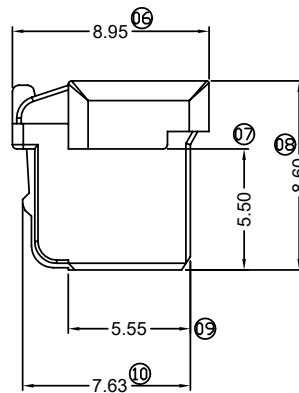

2\*06~2\*09P视图  
比例 1:1

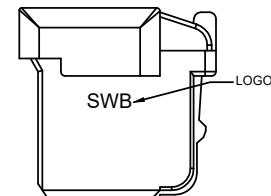

1515 H X-2\*XX X-PT XX  
① ② ③ ④ ⑤ ⑥ ⑦

- ① Series No.
- ② Category :H-HSG
- ③ Appearance type :Blank-Ordinary
- ④ Row No.-Pin No.: 2\*XX-2\*04~2\*14P
- ⑤ Plug the Pin & Special No.:  
Blank-There is no LOGO  
A-With the LOGO
- ⑥ Material : PT-PBT 94V-0
- ⑦ Color: Blank-Natural Color

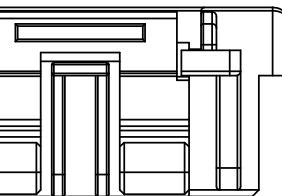
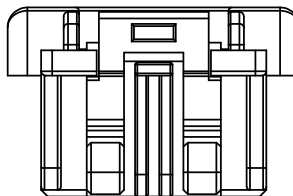
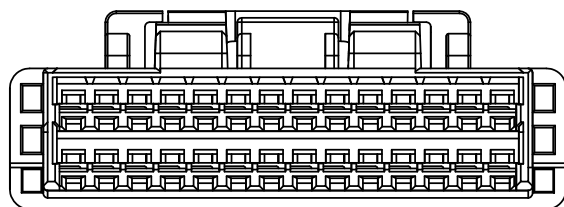

2\*10~2\*14P视图  
比例 1:1

Poles	Dimensions (mm)			Poles	Dimensions (mm)		
	A	B	C		A	B	C
2*04	4.50	10.30	7.25	2*10	13.50	19.30	16.25
2*05	6.00	11.80	8.75	2*11	15.00	20.80	17.75
2*06	7.50	13.30	10.25	2*12	16.50	22.30	19.25
2*07	9.00	14.80	11.75	2*13	18.00	23.80	20.75
2*08	10.50	16.30	13.25	2*14	19.50	25.30	22.25
2*09	12.00	17.80	14.75				

					GENERAL TOLERANCE				PART NO. 1515H-2*XX-PT					
					.X ±0.30				TITLE 1.50mm Crimp Style Connectors					
					.XX ±0.20									
					.XXX±0.10				UNIT SCALE SHEET REV NUMBER					
					X.' ±2'									
2022.05.11	A1	ER20220511001	Modify the rated current parameters	XUOXIAOLONG	PROJECT		APPROVAL		CHECK		DRAWN		DATE	
DATE	REV	ECN NO.	DESCRIPTION	MODIFY	APPROVAL		LARRY		LARRY		XUOXIAOLONG		2021/12/20	

**SMS** 东莞市思索技术股份有限公司  
Dongguan SESO Technology Co.,Ltd.

mm 1:1 1/1 A1 A-000

RoHS

This products can apply to the SWB Doc NO. QA-3-04-005 of Environmental&Material Management Rules

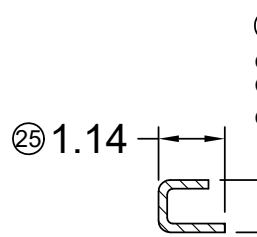
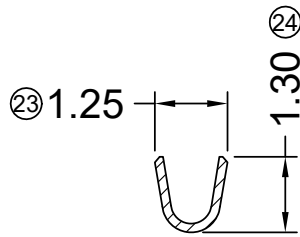
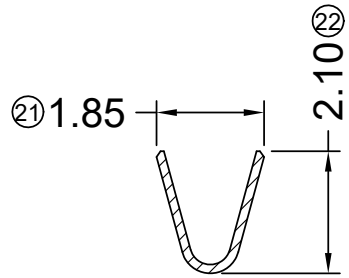
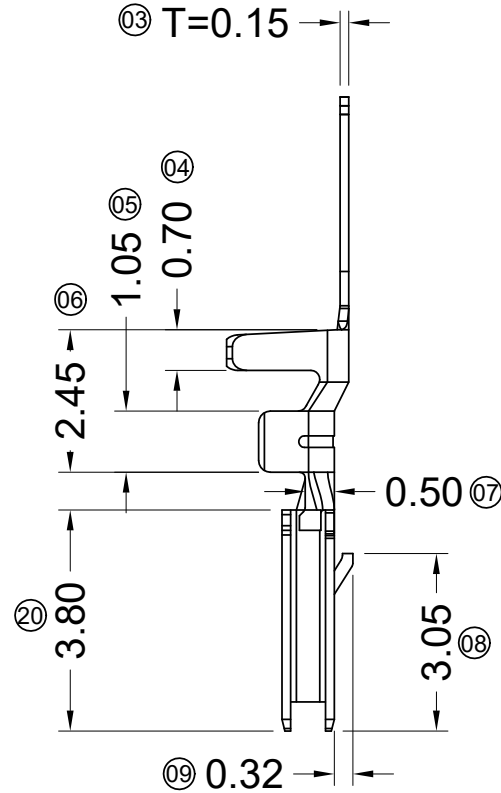
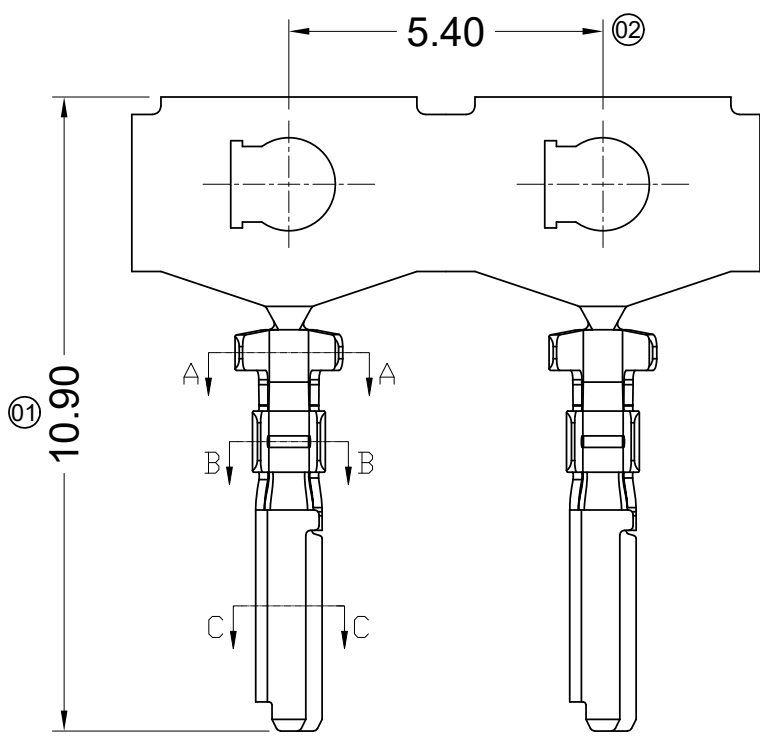

Specifications :

- Voltage rating: 100V AC / DC
- Current rating: 2A AC / DC
- Withstanding voltage: 500V AC/minute
- Temperature range: -40°C~+105°C
- Insulation resistance: ≥500MΩ
- Contact resistance: ≤20mΩ
- After environmental testing: ≤40mΩ
- Material(Pin): Phosphor bronze
- Mates With SWB Housing: 1515H

1515 T X - P SN X - X  
 ① ② ③ ④ ⑤ ⑥ ⑦

- ① Series Number
- ② Category: T-terminal
- ③ Shape: Blank-ordinary
- ④ Material: P-Phosphor bronze
- ⑤ Plating code: SN-Bright tin plating
- ⑥ Plating method:  
Blank-Stamping before plating
- ⑦ Mold No./Mark/Special No.

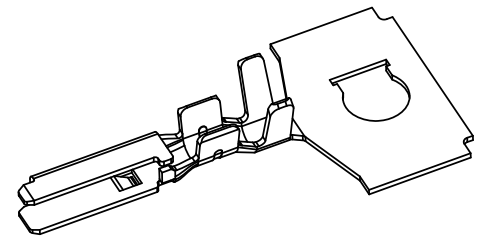

						<p>GENERAL TOLERANCE</p> <p>.X ±0.30</p> <p>.XX ±0.20</p> <p>.XXX ±0.10</p> <p>X.° ±2°</p>				<p>东莞市思索连接器有限公司</p> <p>SWB CONNECTORS CO.,LTD</p>				<p>PART NO. 1515T-PSN</p>												
						<p>APPROVAL</p> <p>Robing</p>				<p>CHECK</p> <p>YYting</p>				<p>DRAWN</p> <p>Wuxiaotao</p>				<p>DATE</p> <p>2018/06/05</p>				<p>TITLE 1.50mm Crimp Style Connectors</p>				
2020.3.17	D	EN20200317002	Update Drawing Frame	YYting	Robing																					
DATE	REV	ECN NO.	DESCRIPTION	MODIFY	APPROVAL																					

RoHS

This products can apply to the SWB Doc NO. QA-3-04-005 of Environmental&Material Management Rules

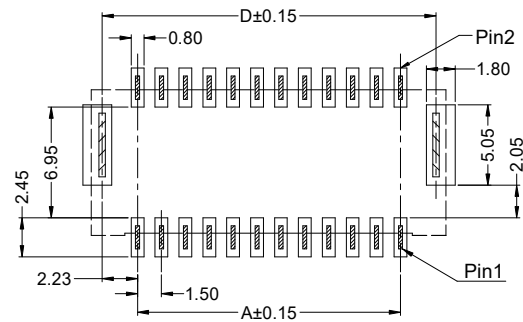
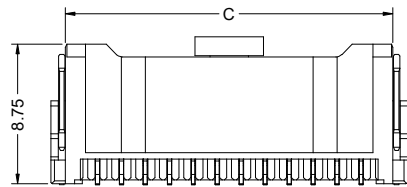
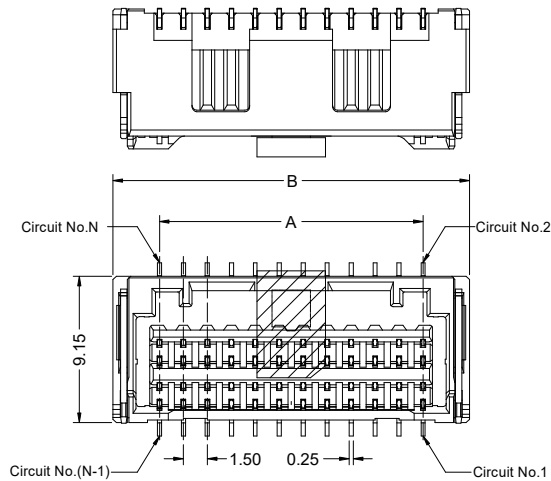

RECOMMENDED P.C.B LAYOUT  
(TOLERANCE:±0.05)

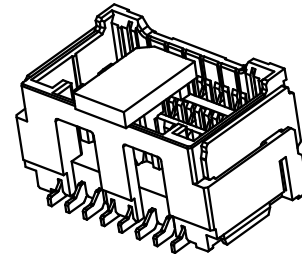
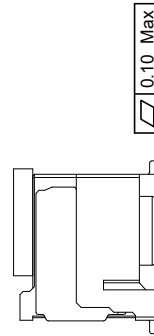

■ Specifications :

- Voltage rating: 100V AC / DC
- Current rating: 1.5 AC / DC
- Withstanding voltage: 500V AC/minute
- Temperature range: -40°C~+105°C
- Insulation resistance:≥500MΩ
- Contact resistance: ≤20mΩ
- After environmental testing: ≤40mΩ

1515 W V S - 2\*XX X- LP SW XX  
① ②③④ ⑤ ⑥ ⑦ ⑧ ⑨

- ① Series No.
- ② Category: W-wafer
- ③ Welding Board Angle: V- Straight 180°
- ④ Welding Way: S-SMT
- ⑤ Row No.-Pin No.: 2\*XX-2\*04P~2\*14P
- ⑥ Plug the Pin & Special No.:
- ⑦ Material: LP -LCP 94V-0 ;
- ⑧ Planting Category:  
SW-Ni50u" min,matte TIN 100u"min
- ⑨ Color: Blank-Natural Color

Poles	Dimensions (mm)				Poles	Dimensions (mm)			
	A	B	C	D		A	B	C	D
2*04	4.50	10.30	8.50	8.95	2*11	15.00	20.80	19.00	19.45
2*05	6.00	11.80	10.00	10.45	2*12	16.50	22.30	20.50	20.95
2*06	7.50	13.30	11.50	11.95	2*13	18.00	23.80	22.00	22.45
2*07	9.00	14.80	13.00	13.45	2*14	19.50	25.30	23.50	23.95
2*08	10.50	16.30	14.50	14.95					
2*09	12.00	17.80	16.00	16.45					
2*10	13.50	19.30	17.50	17.95					

					<p>GENERAL TOLERANCE</p> <p>.X ±0.30</p> <p>.XX ±0.20</p> <p>.XXX ±0.10</p> <p>X.° ±2°</p>				<p>东莞市思索连接器有限公司</p> <p>SWB CONNECTORS CO.,LTD</p>				<p>PART NO.</p> <p>1515WVS-2*XX-LPSW</p>				
					<p>APPROVAL</p> <p>CHECK</p> <p>DRAWN</p> <p>DATE</p>				<p>TITLE</p> <p>1.50mm Crimp Style Connectors</p>								
2022/05/11	A2	ER20220511001	Modify the rated current parameters	XUEXIAOLONG													
DATE	REV	ECN NO.	DESCRIPTION	MODIFY	APPROVAL					UNIT	SCALE	SHEET	REV	NUMBER			
						<p>PROJECT</p> <p>XUEXIAOLONG</p> <p>2021/12/20</p>				mm	1:1	1/2	A2	A-000			

RoHS

This products can apply to the SWB Doc NO. QA-3-04-005 of Environmental&Material Management Rules

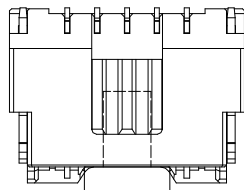

2\*04P~2\*05P Shape  
Scale 1:1

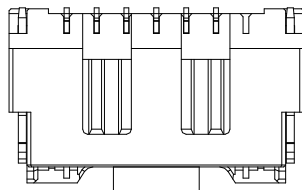

2\*06P~2\*09P Shape  
Scale 1:1

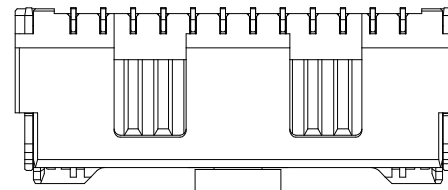

2\*10P~2\*14P Shape  
Scale 1:1

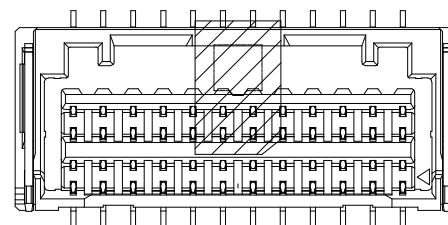
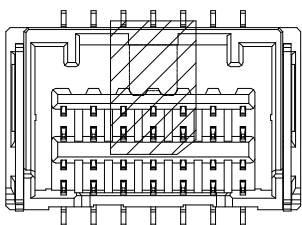
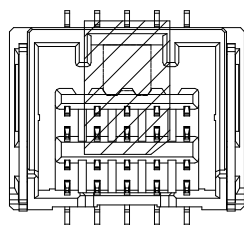

						GENERAL TOLERANCE	 <b>东莞市思索连接器有限公司</b> <b>SWB CONNECTORS CO.,LTD</b>				PART NO. 1515WVS-2*XX-LPSW				
						.X ±0.30					TITLE 1.50mm Crimp Style Connectors				
						.XX ±0.20									
						.XXX ±0.10									
2022/05/11	A2	ER20220511001	Modify the rated current parameters	Xuexiaolong		X.° ±2°	APPROVAL	CHECK	DRAWN	DATE	UNIT	SCALE	SHEET	REV	NUMBER
DATE	REV	ECN NO.	DESCRIPTION	MODIFY	APPROVAL	PROJECT			XUEXIAOLONG	2021/12/20	mm	1:1	2/2	A2	A-000



东莞市思索连接器有限公司  
SWB CONNECTORS CO.,LTD

PART NO. 1515WVS-2*XX-LPSW				
TITLE 1.50mm Crimp Style Connectors				
UNIT	SCALE	SHEET	REV	NUMBER
mm	1:1	2/2	A2	A-000

RoHS

This products can apply to the SWB Doc NO. QA-3-04-005 of Environmental&Material Management Rules

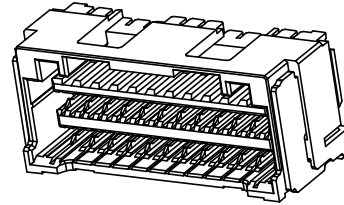
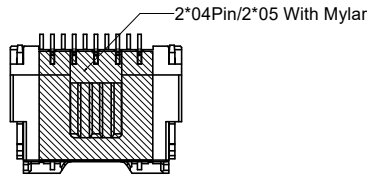
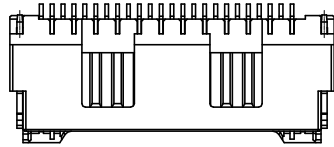

2\*04PIN  
2\*05 PIN

**Specifications :**

- Voltage rating: 100V AC / DC
- Current rating: 1.5A AC/DC
- Withstanding voltage: 500V AC/minute
- Temperature range: -40°C~+105°C
- Insulation resistance: ≥500MΩ
- Contact resistance: ≤20mΩ
- After environmental testing: ≤40mΩ

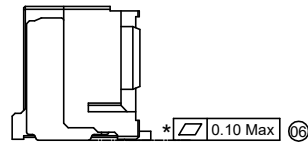
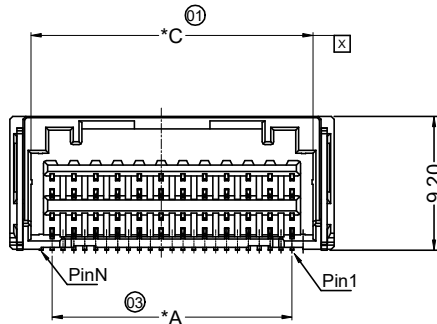

1515 W R S - 2\*XX X- LP SW XX X  
① ②③④ ⑤ ⑥ ⑦ ⑧ ⑨ ⑩

- ① Series No.
- ② Category: W-wafer
- ③ Welding Board Angle: R- Straight 90°
- ④ Welding Way: S-SMT
- ⑤ Row No.-Pin No.: 2\*XX-2\*04P~20\*17P
- ⑥ Plug the Pin & Special No.:
- ⑦ Material: LP -LCP 94V-0 ;
- ⑧ Planting Category:  
SW-Ni50u" min,matte TIN 100u"min
- ⑨ Color: Blank-Natural Color
- ⑩ W-Reel ,With Mylar

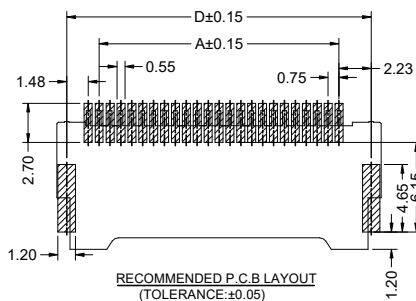
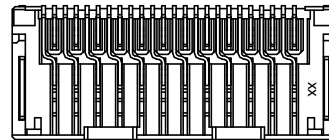
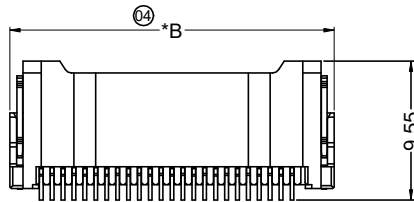

1515WRS-2*XX-LPSW	LCP UL 94V-0	Phosphor Bronze	Brass	Matte Tin-Plated	1515H-2*XX
PART NO	Material	Material(Pin)	Material (Solder Tabs)	Finish (Pin And Solder Tabs)	Mates With SWB Housing

Poles	Dimensions (mm)				Poles	Dimensions (mm)			
	A	B	C	D		A	B	C	D
04	4.50	10.30	7.40	8.95	11	15.00	20.80	17.90	19.45
05	6.00	11.80	8.90	10.45	12	16.50	22.30	19.40	20.95
06	7.50	13.30	10.40	11.95	13	18.00	23.80	20.90	22.45
07	9.00	14.80	11.90	13.45	14	19.50	25.30	22.40	23.95
08	10.50	16.30	13.40	14.95					
09	12.00	17.80	14.90	16.45					
10	13.50	19.30	16.40	17.95					

					GENERAL TOLERANCE	PART NO.								
					.X ±0.30	1515WRS-2*XX-LPSWW								
					.XX ±0.20	TITLE								
					.XXX ±0.10	1.50mm Crimp Style Connectors								
					X.° ±2°	APPROVAL	CHECK	DRAWN	DATE	UNIT	SCALE	SHEET	REV	NUMBER
2022/05/11	A2	ER20220511001	Modify the rated current parameters	XUEXIAOLONG	PROJECT					mm	1:1	1/2	A2	A-000
DATE	REV	ECN NO.	DESCRIPTION	MODIFY	APPROVAL			XUEXIAOLONG	2021/12/20					



东莞市思索连接器有限公司  
SWB CONNECTORS CO.,LTD

PART NO.				
1515WRS-2*XX-LPSWW				
TITLE				
1.50mm Crimp Style Connectors				
UNIT	SCALE	SHEET	REV	NUMBER
mm	1:1	1/2	A2	A-000

RoHS

This products can apply to the SWB Doc NO. QA-3-04-005 of Environmental&Material Management Rules

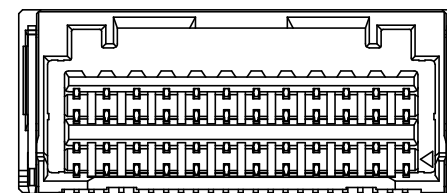
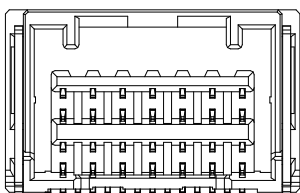
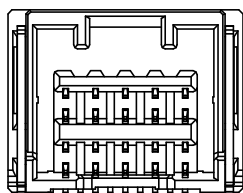
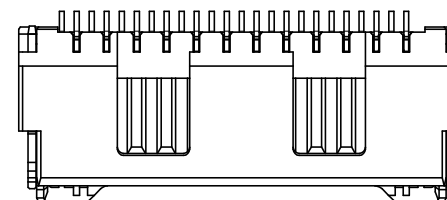
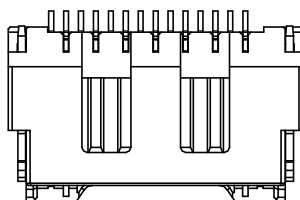
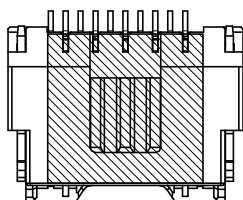

2\*04P~2\*05P Shape  
Scale 1:1

2\*06P~2\*09P Shape  
Scale 1:1

2\*10P~2\*14P Shape  
Scale 1:1

					<b>GENERAL TOLERANCE</b> .X ±0.30 .XX ±0.20 .XXX ±0.10 X.° ±2°				<b>东莞市思索连接器有限公司</b> <b>SWB CONNECTORS CO.,LTD</b>				<b>PART NO.</b> 1515WRS-2*XX-LPSWW			
					PROJECT 				<b>APPROVAL</b> <b>CHECK</b> <b>DRAWN</b> <b>DATE</b>				<b>TITLE</b> 1.50mm Crimp Style Connectors			
2022/05/11	A2	ER20220511001	Modify the rated current parameters	Xuexiaolong									UNIT    SCALE    SHEET    REV    NUMBER mm    1:1    2/2    A2    A-000			
DATE	REV	ECN NO.	DESCRIPTION	MODIFY	APPROVAL											