

RoHS

This products can apply to the SESO Doc NO. QA-3-04-005 of Environmental&Material Management Rules

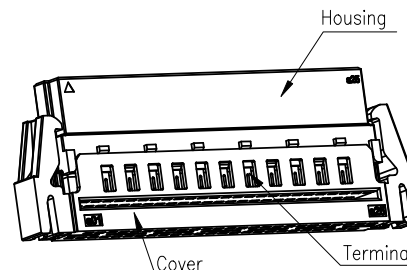

- Specifications :
- Voltage rating: 125V AC / DC
 - Current rating: 1.7A AC / DC
 - Withstanding voltage: 500V AC/minute
 - Temperature range: -40°C~+125°C
 - Insulation resistance: >100MΩ
 - Contact resistance: <25mΩ

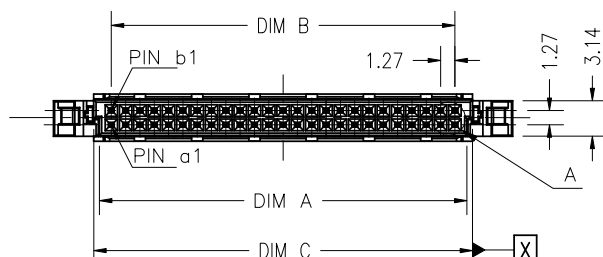
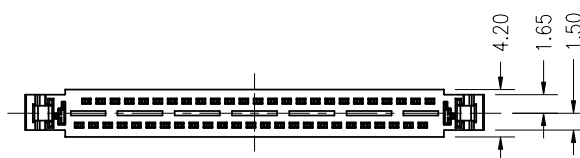
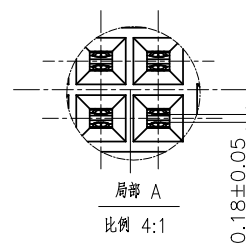
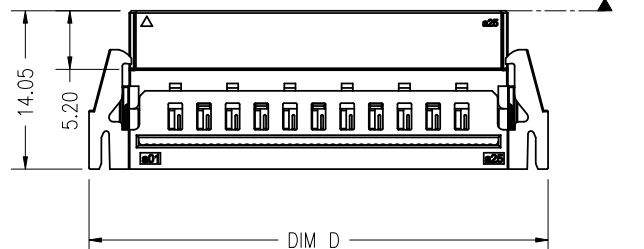
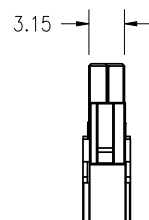

1278 H I - 2*XX-LP GWXX B T
① ② ③ ④ ⑤ ⑥ ⑦ ⑧

- ① Series No.
- ② Category: H-Housing
- ③ Shape: I-HSG+Metals
- ④ Row No.-Pin No: 2*XX-Double Row 2*XXPin
- ⑤ Plastic material: LP- LCP UL94V-0;
- ⑥ Plating Code: See Table 1
- ⑦ Color: B-Black
- ⑧ Packing: T-Tray

See Table 1:

| PIN 号 | 尺寸 | DIM. A | DIM. B | DIM. C | DIM. D | PIN 号 | 尺寸 | DIM. A | DIM. B | DIM. C | DIM. D | |
|-------|------|--|--------|--------|--------|-------|-------|--------|--------|--------|--------|-------|
| | | | | | | | | | | | | PIN 号 |
| 1 | GW05 | Contant Area Plating Au 5u",80u"Sn MIN. plating,30u"MIN.nickel underplated overall | 2*06 | 8.47 | 6.35 | 9.47 | 16.60 | 2*20 | 26.25 | 24.13 | 27.25 | 34.38 |
| | | | 2*08 | 11.01 | 8.89 | 12.01 | 19.14 | 2*25 | 32.60 | 30.48 | 33.60 | 40.73 |
| 2 | GW15 | Contant Area Plating Au 15u",80u"Sn MIN. plating,30u"MIN. nickel underplated overall | 2*10 | 13.55 | 11.43 | 14.55 | 21.68 | 2*34 | 44.03 | 41.91 | 45.03 | 52.16 |
| | | | 2*13 | 17.36 | 15.24 | 18.36 | 25.49 | 2*40 | 51.65 | 49.53 | 52.65 | 59.78 |
| 3 | GW30 | Contant Area Plating Au 30u",80u"Sn MIN. plating,30u"MIN. nickel underplated overall | 2*16 | 21.17 | 19.05 | 22.17 | 29.30 | | | | | |

| | | | | | | | | | | | | | | |
|----------|-----|---------|--|--------|----------|-------------------|------|------|------------|--|-------|-------|------|--------|
| 20230811 | X1 | / | Cancel the change of shrapnel, improve the fastening force of the buckle, and modify the size of the rear plug | YUAN | Yang | GENERAL TOLERANCE | | | | PART NO. | | | | |
| | | | | | | .X ±0.35 | | | | 1278HI-2*XX-LPGWXXBT | | | | |
| | | | | | | .XX ±0.25 | | | | TITLE 1.27mm PITCH Double RowWTB Connector | | | | |
| | | | | | | .XXX±0.15 | | | | APPROVAL | CHECK | DRAWN | DATE | |
| 20221128 | X0 | / | Initial release | YUAN | Yang | PROJECT | | | | UNIT | SCALE | SHEET | REV | NUMBER |
| DATE | REV | ECN NO. | DESCRIPTION | MODIFY | APPROVAL | zhang | Yang | YUAN | 2023/05/25 | mm | 1:1 | 1/1 | X1 | CD |

RoHS

This products can apply to the SESO Doc NO. QA-3-04-005 of Environmental&Material Management Rules

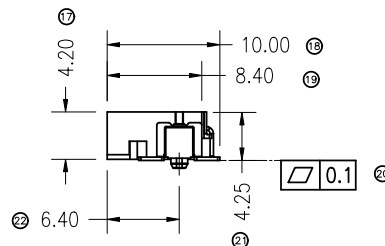
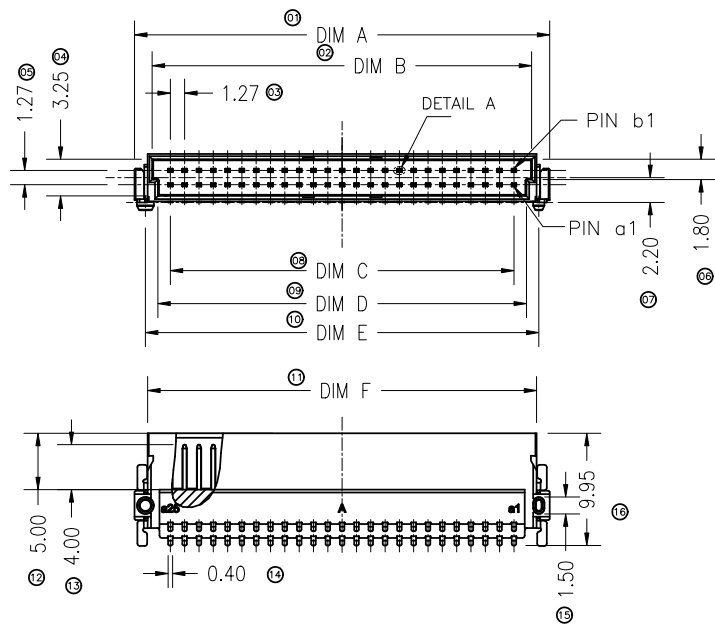
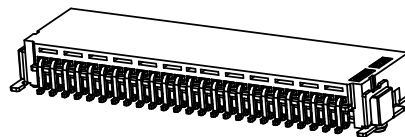

Specifications :

- Voltage rating: 125V AC / DC
- Current rating: 1.7A AC / DC
- Withstanding voltage: 500V AC/minute
- Temperature range: -40°C~+125°C
- Insulation resistance:>100MΩ
- Contact resistance: <25mΩ

| ◆ DIM. PIN NO. | DIM. A | DIM. B | DIM. C | DIM. D | DIM. E | DIM. F |
|----------------|--------|--------|--------|--------|--------|--------|
| 2*06 | 12.70 | 9.57 | 6.35 | 8.57 | 10.77 | 10.37 |
| 2*08 | 15.24 | 12.11 | 8.89 | 11.11 | 13.31 | 12.91 |
| 2*10 | 17.78 | 14.65 | 11.43 | 13.65 | 15.85 | 15.45 |
| 2*13 | 21.59 | 18.46 | 15.24 | 17.46 | 19.66 | 19.26 |
| 2*16 | 25.40 | 22.27 | 19.05 | 21.27 | 23.47 | 23.07 |
| 2*20 | 30.48 | 27.35 | 24.13 | 26.35 | 28.55 | 28.15 |
| 2*25 | 36.83 | 33.70 | 30.48 | 32.70 | 34.90 | 34.50 |
| 2*34 | 48.26 | 45.13 | 41.91 | 44.13 | 46.33 | 45.93 |
| 2*40 | 55.88 | 52.75 | 49.53 | 51.75 | 53.95 | 53.55 |

1278 WRS - 2*XX - LP GW01 BRS
 ① ② ③ ④ ⑤ ⑥ ⑦ ⑧ ⑨ ⑩

- ① Series No.1278
- ② Category: W-wafer
- ③ Shape: R- 90°
- ④ Mounting Type: S-SMT
- ⑤ Row No.-Pin No: 2*XX-Double Row 2*XXPin
- ⑥ Plastic material: LP- LCP UL94V-0;
- ⑦ Plating Code: GW01-Contant Area Plating Au Gold Flash",80u"Sn MIN. plating,30u"MIN. nickel underplated overall
- ⑧ Color: B-Black
- ⑨ Packing: R-Reel
- ⑩ Special code :S

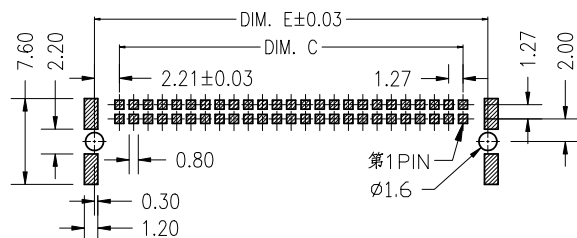

RECOMMENDED PCB LAYOUT (TOLERANCE:±0.05)

| DATE | REV | ECN NO. | DESCRIPTION | MODIFY | APPROVAL | PROJECT | | | | PART NO. | | | | |
|----------|-----|---------|-----------------------------|--------|------------|------------|------------|-------|------------|--|-------|-------|-----|--------|
| | | | | | | APPROVAL | CHECK | DRAWN | DATE | UNIT | SCALE | SHEET | REV | NUMBER |
| 20220830 | X1 | / | Modify buttons and add ribs | YUAN | Larry Yang | Jack Zhang | Larry Yang | YUAN | 2022/11/28 | 1278WRS-2*XX-LPGW01BRS | | | | |
| 20221128 | X0 | / | Initial release | YUAN | Larry Yang | | | | | TITLE 1.27mm PITCH Double RowWTB Connector | | | | |
| | | | | | | mm | 1:1 | 1/1 | X1 | CD | | | | |

SMS 东莞市思索技术股份有限公司
 Dongguan SESO Technology Co.,Ltd.

RoHS

This products can apply to the SESO Doc NO. QA-3-04-005 of Environmental&Material Management Rules

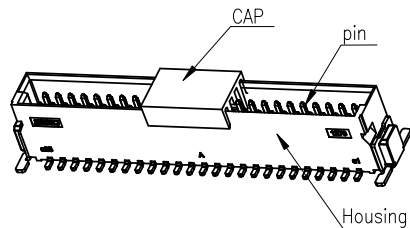
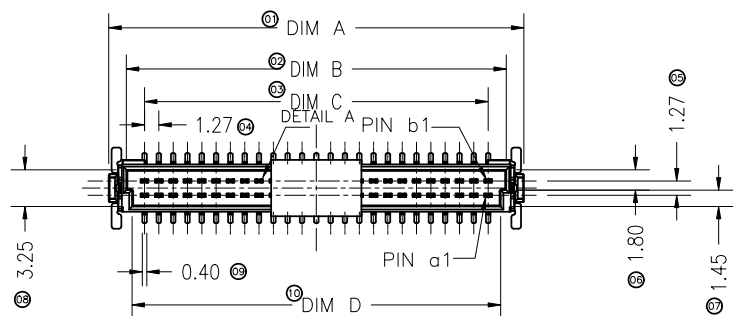

Specifications :

- Voltage rating: 125V AC / DC
- Current rating: 1.7A AC / DC
- Withstanding voltage: 500V AC/minute
- Temperature range: -40°C~+125°C
- Insulation resistance: >100MΩ
- Contact resistance: <25mΩ

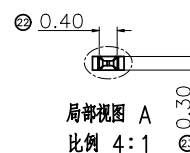
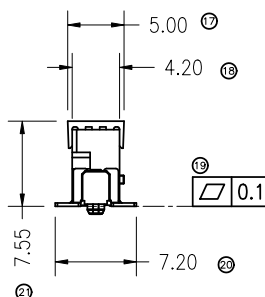
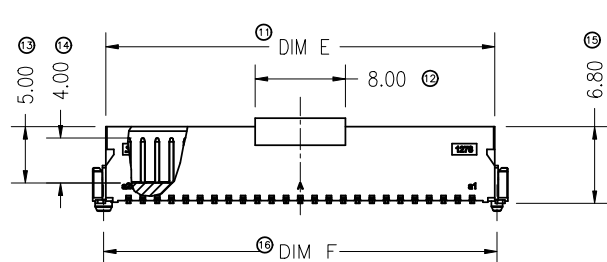

1278 W V S - 2*XX - LP GW01 B C S
① ② ③ ④ ⑤ ⑥ ⑦ ⑧ ⑨ ⑩

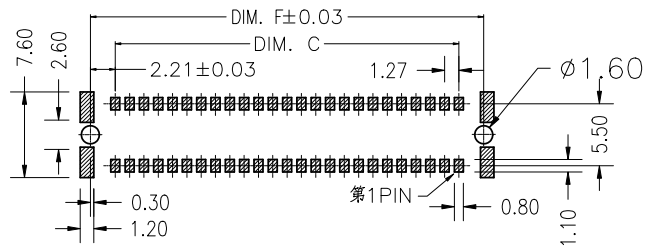

RECOMMENDED PCB LAYOUT (TOLERANCE:±0.05)

| ROW NO. / PIN # | DIM. A | DIM. B | DIM. C | DIM. D | DIM. E | DIM. F |
|-----------------|--------|--------|--------|--------|--------|--------|
| 2*06 | 12.70 | 9.57 | 6.35 | 8.57 | 10.37 | 10.77 |
| 2*08 | 15.24 | 12.11 | 8.89 | 11.11 | 12.91 | 13.31 |
| 2*10 | 17.78 | 14.65 | 11.43 | 13.65 | 15.45 | 15.85 |
| 2*13 | 21.59 | 18.46 | 15.24 | 17.46 | 19.26 | 19.66 |
| 2*16 | 25.40 | 22.27 | 19.05 | 21.27 | 23.07 | 23.47 |
| 2*20 | 30.48 | 27.35 | 24.13 | 26.35 | 28.15 | 28.55 |
| 2*25 | 36.83 | 33.70 | 30.48 | 32.70 | 34.50 | 34.90 |
| 2*34 | 48.26 | 45.13 | 41.91 | 44.13 | 45.93 | 46.33 |
| 2*40 | 55.88 | 52.75 | 49.53 | 51.75 | 53.55 | 53.95 |

- ① Series No.1278
- ② Category:W-wafer
- ③ Shape: V- 180°
- ④ Mounting Type: S-SMT
- ⑤ Row No.-Pin No: 2*XX-Double Row 2*XXPin
- ⑥ Plastic material: LP- LCP UL94V-0;
- ⑦ Plating Code:GW01-Contant Area Plating Au Gold Flash”, 0u”Sn MIN.plating,30u”MIN. nickel underplated overall
- ⑧ Color:B-Black
- ⑨ Packing:C-Reel and Cap
- ⑩ Special code :S

| DATE | REV | ECN NO. | DESCRIPTION | MODIFY | APPROVAL | GENERAL TOLERANCE | | | | PROJECT | APPROVAL | | | | PART NO. | | | | | | | |
|----------|-----|---------|-----------------------------|--------|------------|-------------------|-------|-----|-------|---------|----------|-------|-----|--|------------|-------|------------|--------------------------------|------|-------|-------|-----|
| | | | | | | .X | ±0.35 | .XX | ±0.25 | | .XXX | ±0.15 | X' | ±2' | APPROVAL | CHECK | DRAWN | DATE | UNIT | SCALE | SHEET | REV |
| 20230830 | X1 | / | Modify buttons and add ribs | YUAN | Larry Yang | .X | ±0.35 | .XX | ±0.25 | .XXX | ±0.15 | X' | ±2' | Jack Zhang | Larry Yang | YUAN | 2023/08/30 | PART NO. 1278WVS-2*XX-LPGW01CS | | | | |
| 20221128 | X0 | / | Initial release | YUAN | Larry Yang | | | | | | | | | TITLE 1.27mm PITCH Double RowWTB Connector | | | | | | | | |
| | | | | | | | | | | | | mm | 1:1 | 1/1 | X1 | CD | | | | | | |

SMS 东莞市思索技术股份有限公司
Dongguan SESO Technology Co.,Ltd.